

505 FIFTH

S U B L E A S E



Entire 23rd Floor | 10,876 RSF

S U B L E A S E

Electric

Direct-metered

HVAC

Individual DX unit for the floor

Sublease thru

July 31, 2030
Open to shorter-term options

Space Features

- » Brand new high-end installation with glass office fronts, bountiful natural light, and expansive views
- » Space is built out with 5 offices, 3 conference rooms, and open space for 28+ people
- » Space also includes an open pantry, ADA bathroom, and wellness room
- » Space will be delivered fully-furnished



Fifth Avenue

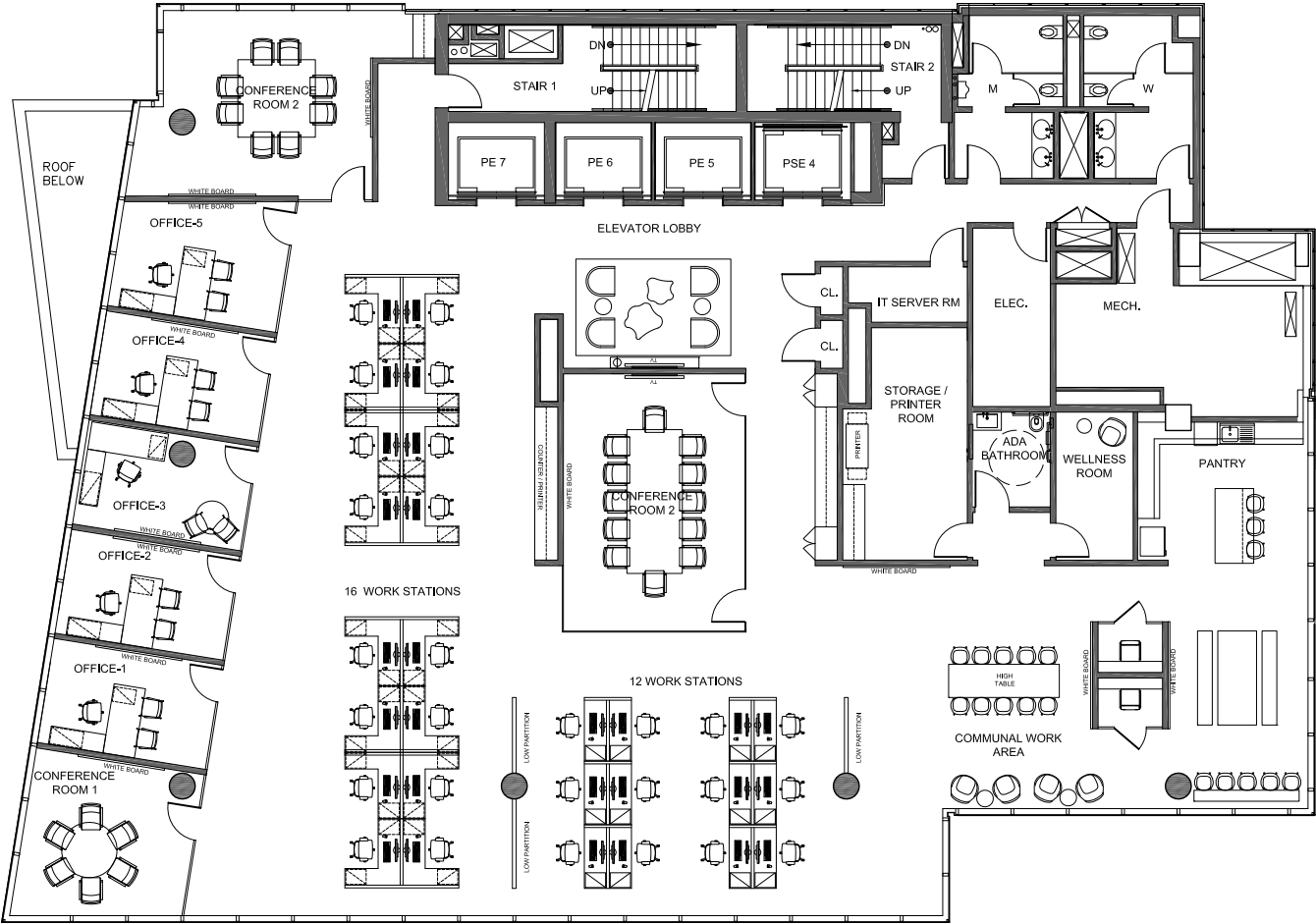

42nd Street

