

# 1 PENN PLAZA

PARTIAL 53RD FLOOR



PROPOSED PENN 1 34TH STREET LOBBY & SOCIAL STAIR



## SUBLEASE

**SIZE:** 13,626 SF

**POSSESSION:** Immediate

**TERM:** Thru April 30, 2025

## SPACE FEATURES:

- High-end recently built sublease space from a financially strong sublandlord
- 14 private offices, four conference rooms, two break out-rooms, open seating for up to 30 people, reception and an eat-in pantry
- Unparalleled views of Hudson Yards and the Hudson River
- 1 Penn Plaza is undergoing a full renovation of its lobby and amenity space to be delivered in March of 2021. The amenity space will include a 36,000 SF fitness center, 20,000 SF of conferencing and a private bar/restaurant for tenant enjoyment

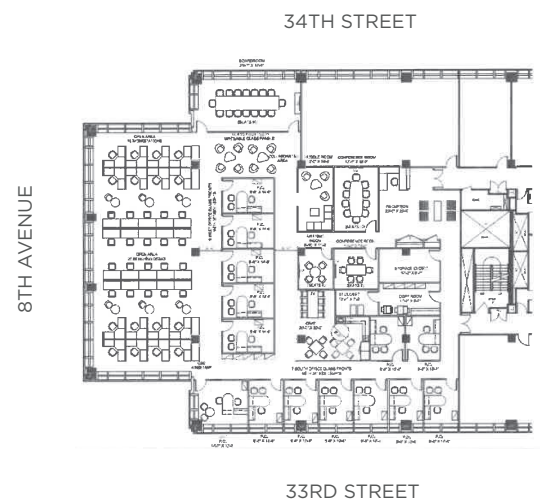

# SPACE PHOTOS

**1 PENN  
PLAZA**  
PARTIAL 53RD FLOOR

