

HEDGE FUND PERFECTION ON BRYANT PARK

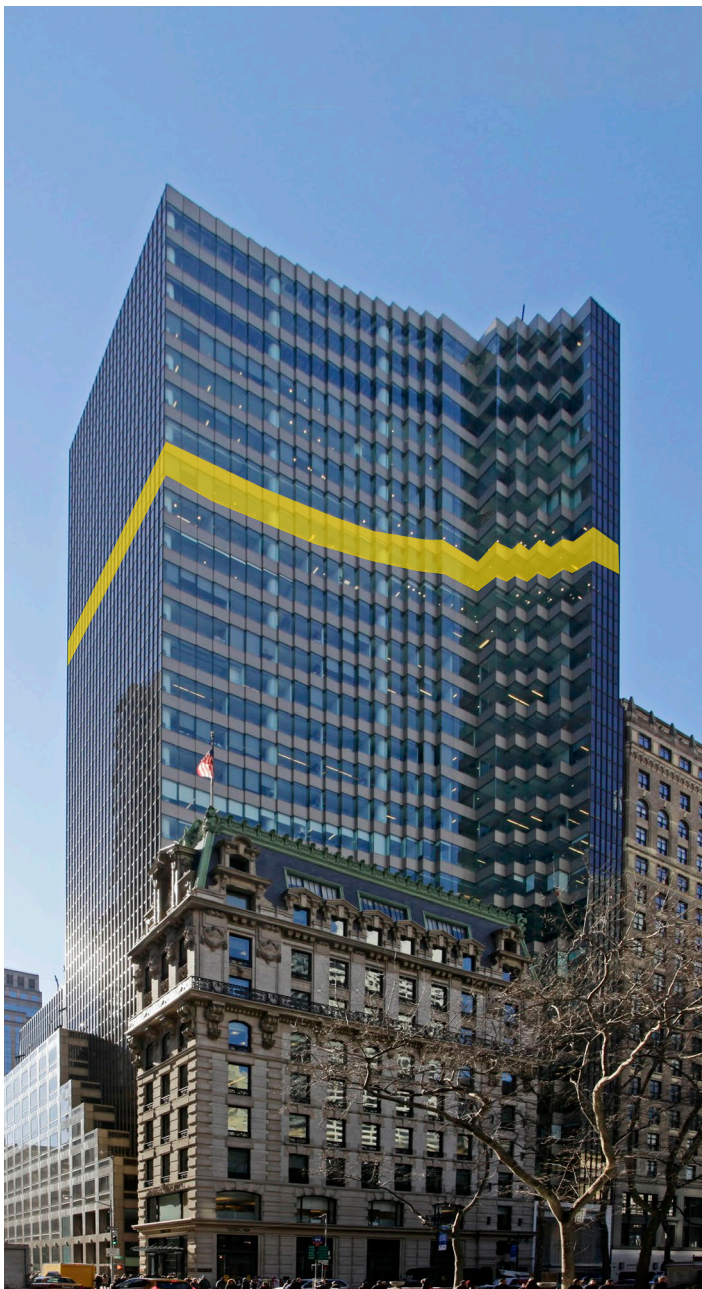

Space Profile

Floor: **Entire 22nd Floor**

Size: **16,428 RSF**

Availability: **Immediate**

Rent: **Upon request**

Sublease Term: **12/30/22**

Key Highlights

- Superbly built and furnished full floor in one of Bryant Park's premier buildings
- Great for hedge funds or other uses that require high density seating including TAMI tenants
- Excellent views
- Aggressively priced
- Immediate possession



**For deals completed by August 1, 2021*

SUBLEASE 452 Fifth Avenue - Bryant Park



SUBLEASE 452 Fifth Avenue - Bryant Park

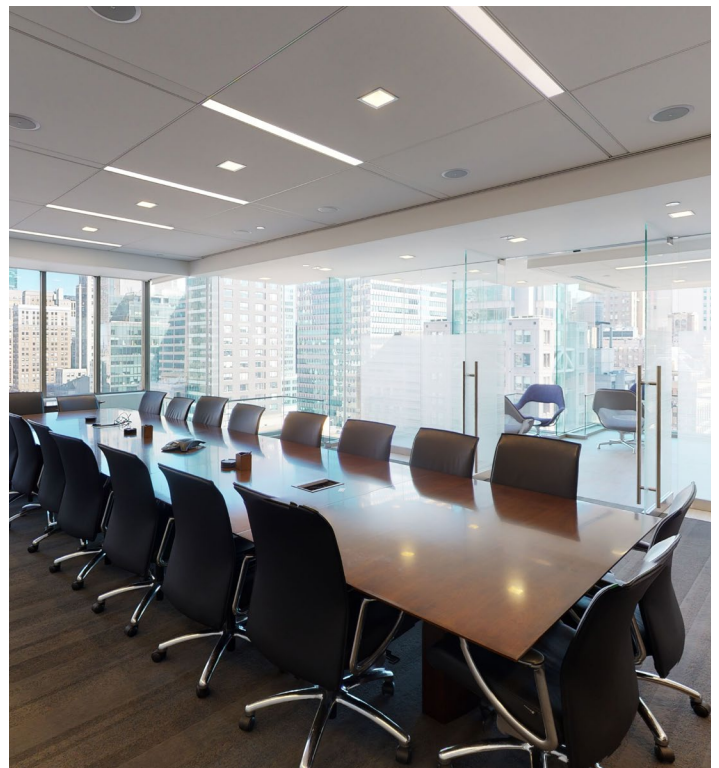

Entire 22nd Floor
16,428 RSF

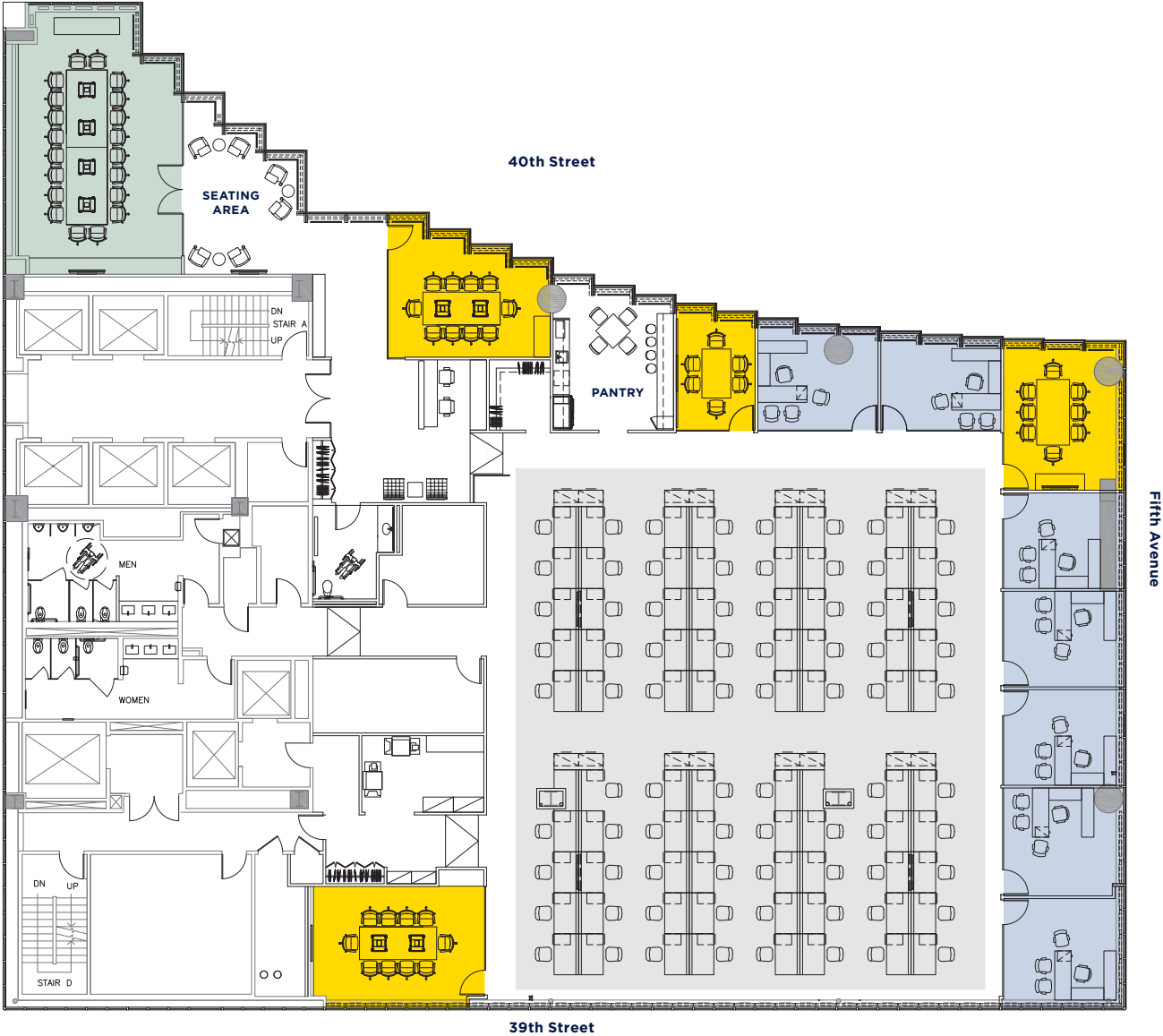

Space Overview

- | | | | | | |
|---|----|--|---|---|--|
| 7 | 7 | windowed offices / breakout rooms | 4 | 4 | conference rooms (6, 8, 10 and 10 seats) |
| 1 | 1 | boardroom (20 seats) | 1 | 1 | large eat-in windowed pantry |
| | 78 | trading positions / high density seating | | | |