

# 450 LEXINGTON AVE

OFFICE FOR LEASE

📍 East Midtown, NY – Between East 44th and 45th St

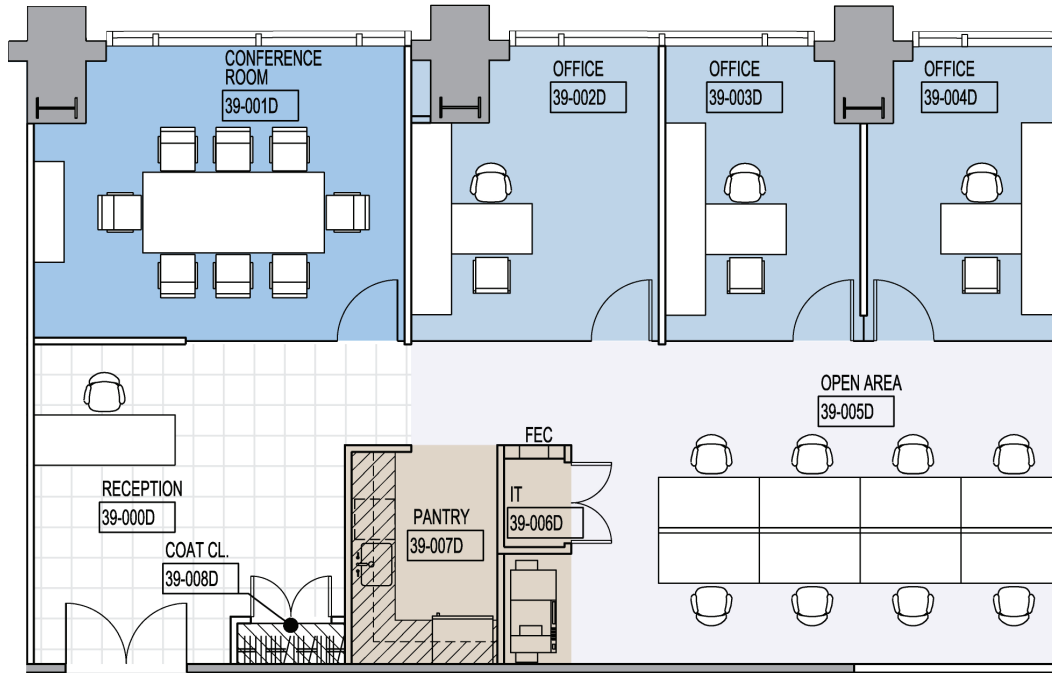

## SUITE D – 2,702 RSF 39TH FLOOR

EXECUTIVE OFFICE	1
PRIVATE OFFICE	2
BENCHING STATIONS	8
RECEPTION	1
CONFERENCE ROOM	1
PANTRY	1
IT ROOM	1
PRINTER AREA	1
<b>TOTAL</b>	<b>16</b>

**CLICK TO WATCH  
A VIDEO TOUR**

### SPACE PROFILE:

**SIZE:** 2,702 SF

**FLOOR:** Partial 39th Fl

**RATE:** Please Call

**AVAILABILITY:** Immediately

### KEY FEATURES:

- The only availability in building
- Quintessential Grand Central
- Brand new buildout, floor-to-ceiling windows, stunning light and views
- Directly off elevator, glass entrance, large reception, conference room and 3 executive offices all with full glass partition and all with light and views
- Full Kitchen/Pantry with stainless appliances, open bullpen area room for up to 12 stations
- Lease Expiration October 31st, 2023
- Furniture available
- Immediate Occupancy