



# 60 EAST 42ND STREET

## ONE GRAND CENTRAL PLACE

### Partial 24th Floor Sublet

---

#### AVAILABLE SPACE

Partial 24th Floor: 5,176 SF

#### ASKING RENT

Upon Request

#### TERM

7 YEARS; SHORTER TERMS  
CONSIDERED

#### POSSESSION

Immediate

#### SPACE DESCRIPTION

- High-End Office Intensive Pre-build
- 9 Offices
- 1 Large Conference Room
- Floor to Ceiling Glass Offices
- Open Area in the Center
- Brand New Modern Furniture can be Included
- Full Kitchen with Water Purifier, Nespresso, and Breville Coffee Machines
- Three Sides of Windows
- Fantastic Views of Grand Central

# 60 EAST 42ND STREET Partial 24th Floor Sublease

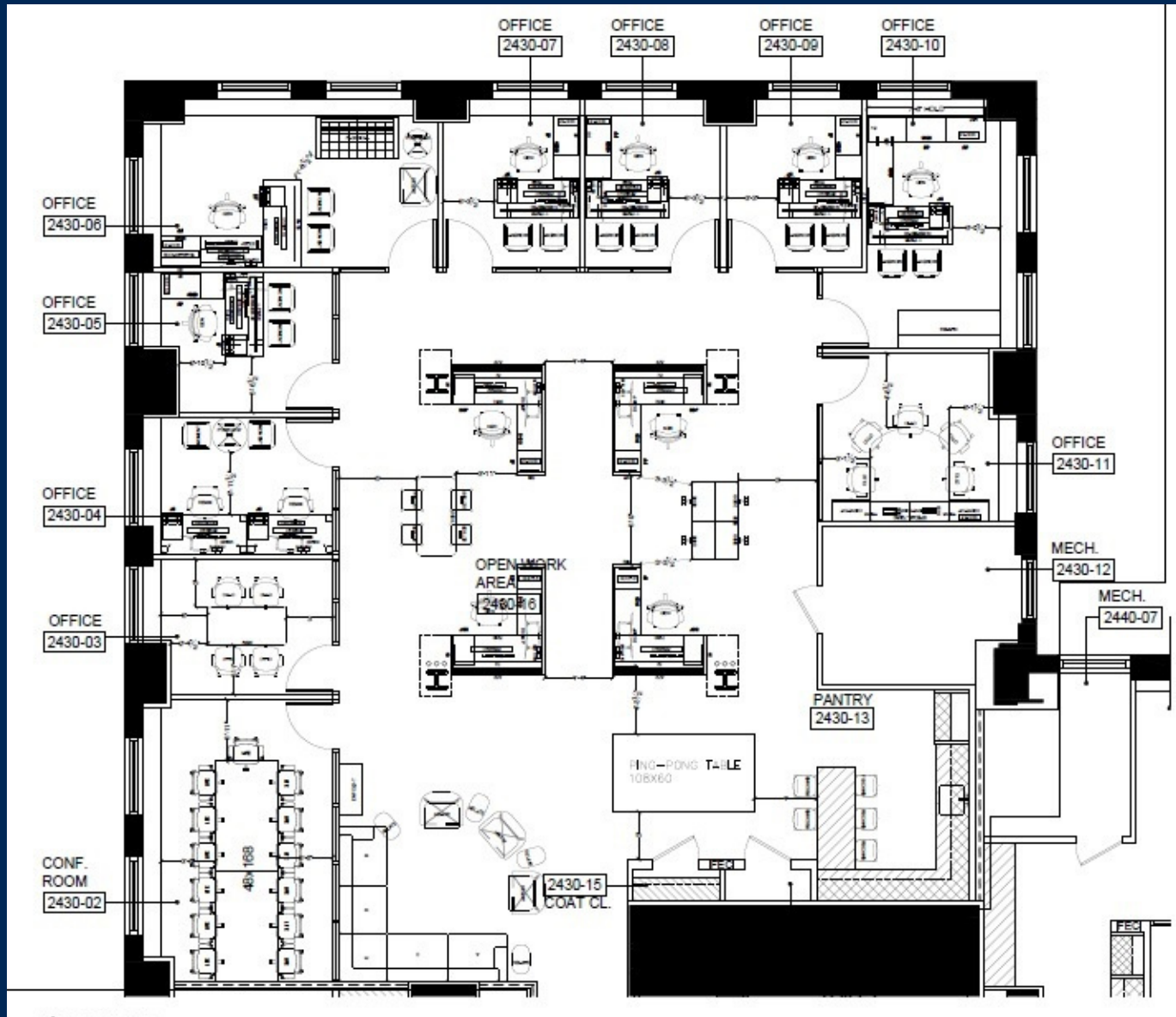



# 60 EAST 42ND STREET Partial 24th Floor Sublease





# 60 EAST 42ND STREET Partial 24th Floor Sublease

