

A low-angle, wide shot of the 237 Park Avenue building in New York City. The building is a modern skyscraper with a dark, metallic facade and large glass windows. The entrance is prominent, featuring large, cylindrical columns and a glass-enclosed area. The number '237' is visible on the building's facade in large, illuminated digits. The sky is clear and blue.

237

PARK AVENUE

66,402 RSF
PRIME GRAND CENTRAL
PLUG & PLAY
SUBLEASE OPPORTUNITY

SPACE FEATURES

FLR	RSF	TERM
E 4	66,402	Thru May 2027

AVAILABILITY DETAILS

- Fully furnished plug-and-play sublease
- Recently built, creative and collaborative installation
- Available Immediately

BUILDING FEATURES

- Brand New Convene conference facility
- Recently renovated lobby and plaza
- Quality Institutional Ownership
- Steps to Grand Central Terminal

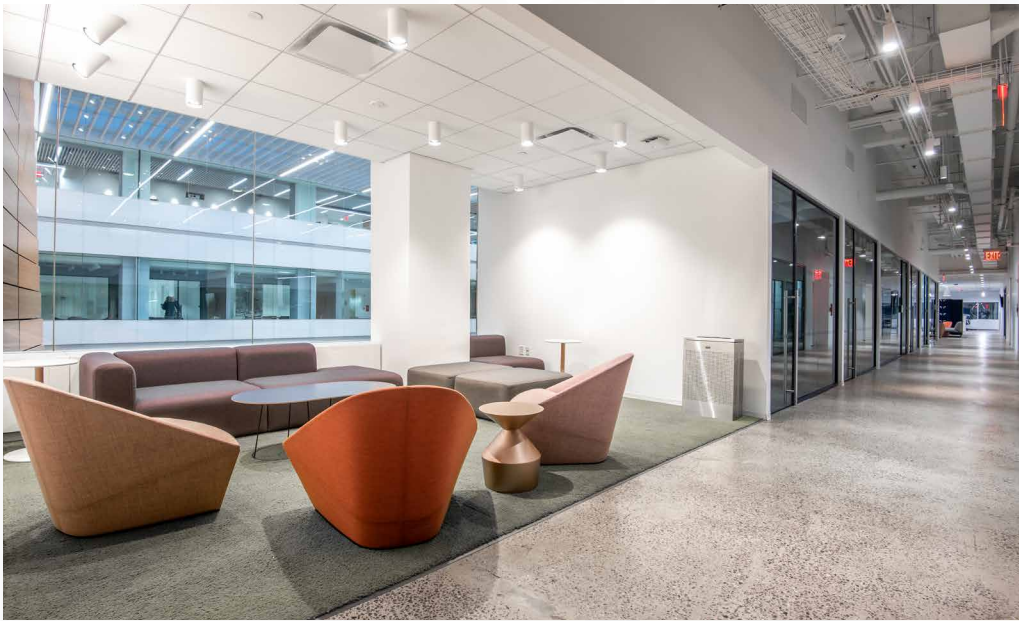

FLOOR PLAN

- Entire 4th Floor - 66,402 RSF

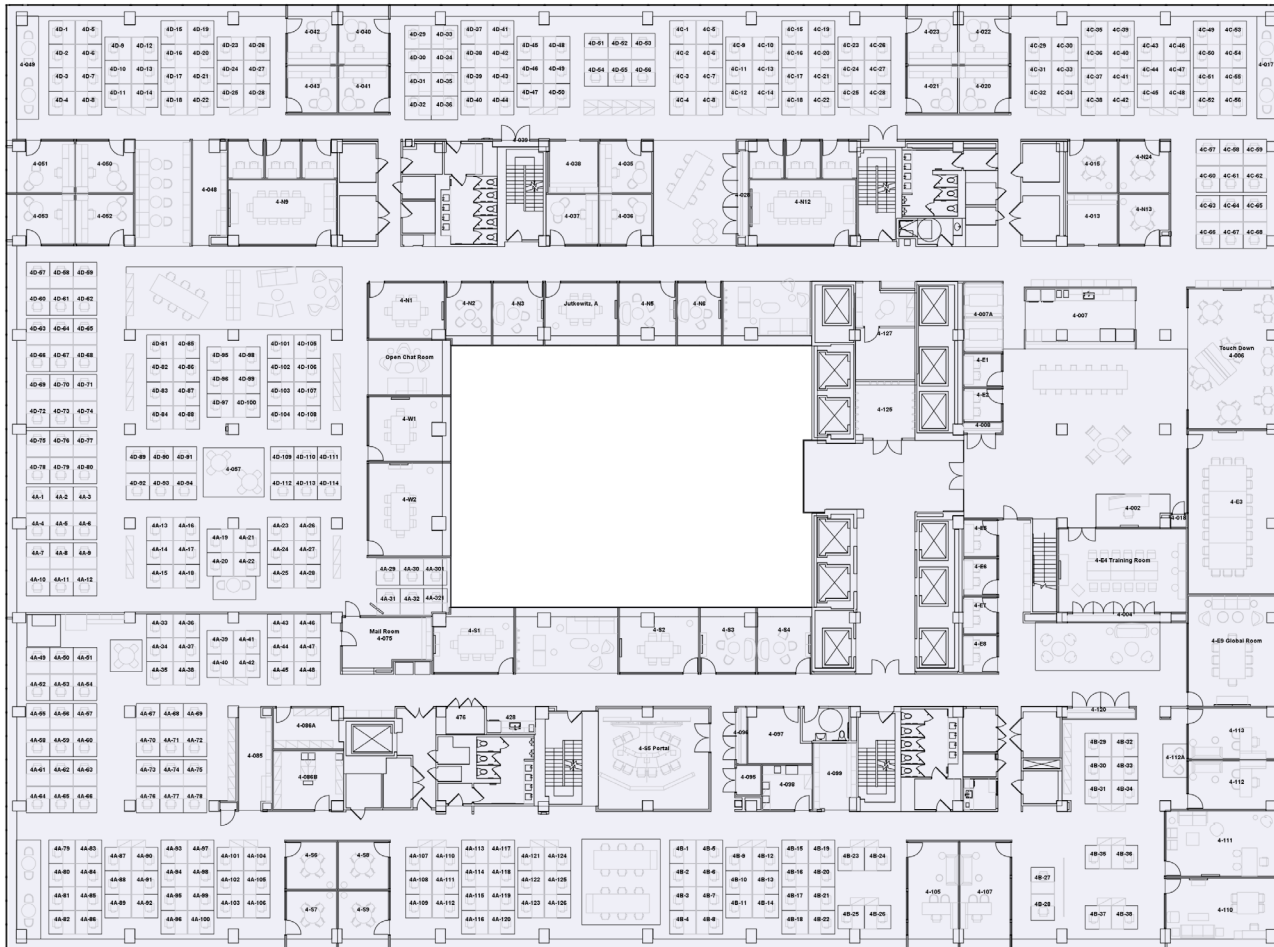

237

4TH FLOOR

- 294 workstations
- 1 Large Conference Room (20p)
- 11 Medium Conference Rooms (8-10p)
- 7 Small Huddle Rooms (3-6p)
- 13 Phone Rooms

