

AVAILABILITY IN THE HEART OF THE PLAZA DISTRICT



Space Profile

Size: **9,680-20,160 SF (will divide)**

Floor(s): **Partial 30th (Western Tower)**

Rate: **Please inquire**

Availability: **March 2021**

Term: **3-10 years**

Key Highlights

- Brand new prebuilt that will come fully furnished with 32 workstations, 8 offices, 4 conference rooms and 2 phone booths
- Electricity is sub-metered
- 5-10 minute walk from the following transit lines:



Partial 30th Floor (Western Tower)

9,680 SF

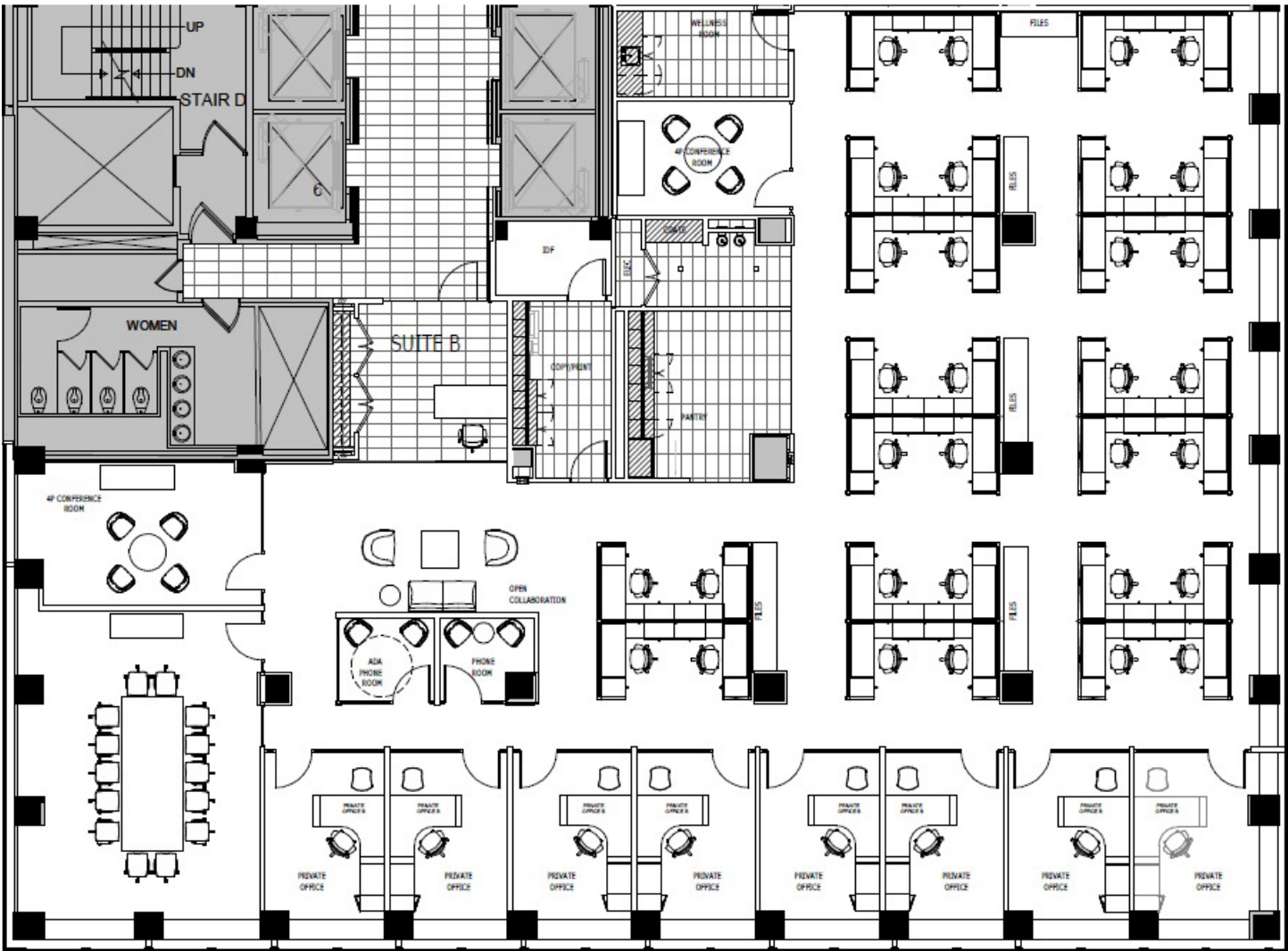

Partial 30th Floor (Western Tower)

9,680 SF Test Fit

