

589

EIGHTH AVENUE

- **Furnished, Pre Wired,
Move in Ready Full
Floors**
- **Plug and Play Pre
Built Opportunities**



589 Eighth Avenue

Suite	Approximate Size	Rent	Possession	Term
Entire 6 th Floor	5,200 RSF	Inquire	Immediate	Negotiable

Comments

- Seven (7) windowed offices, including Executive corner office and a potential two (2) person office
- Large, 10-12 person conference room
- Large open area with twenty two (22) workstations and reception/lounge area
- Break/phone/meeting room next to pantry.
- Three (3) bathrooms including unisex ADA
- Wet pantry with stainless steel appliances and black granite counters, polished concrete floors

Building and Pre Built Features

- Fully furnished, plug-and-play, move in condition
- Tenant – controlled central A/C, 11' high ceilings
- Sub – metered electric, FIOS & Spectrum Fiber, fully pre-wired w/CAT 6 high – speed internet, telephone & data
- 24 – hour/ 7 – day access
- Three state-of-the-art modernized passenger elevators
- Steps away from public transportation

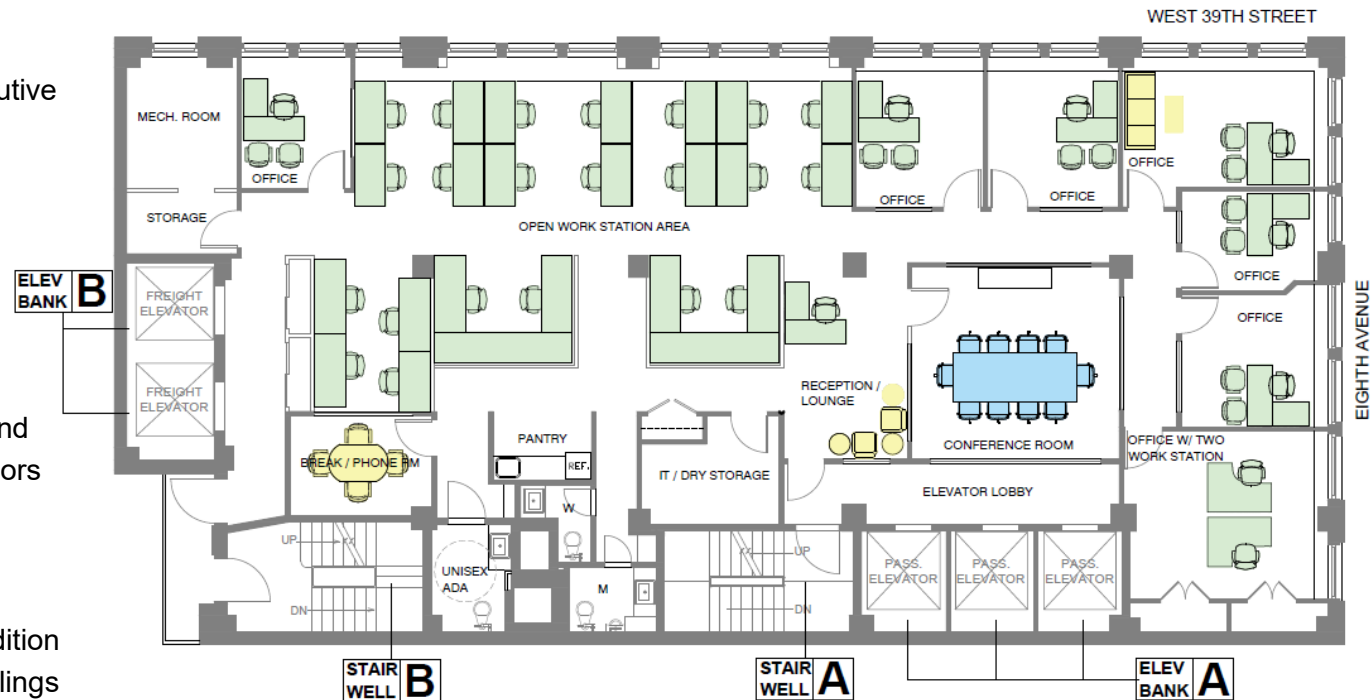

589 Eighth Avenue

6th Floor

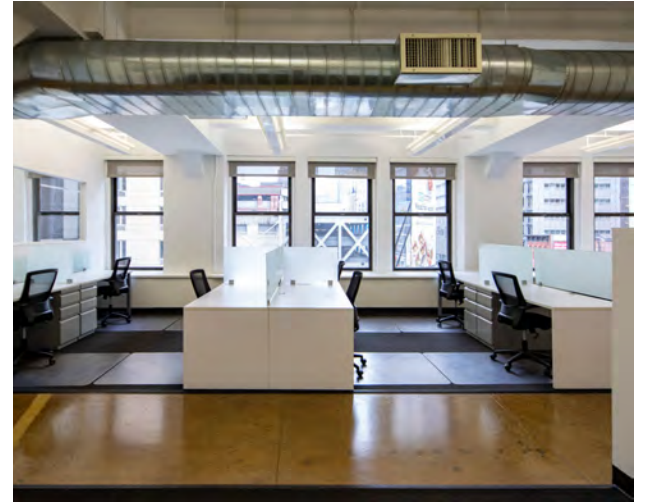

589 Eighth Avenue

Suite	Approximate Size	Rent	Possession	Term
Entire 8 th Floor	5,200 RSF	Inquire	Immediate	Negotiable

Comments

- Recently pre-built plug-and-play move-in condition installation with 8 glass-fronted offices, glass-enclosed conference room, open central windowed area with 20 large workstations, reception.
- 3 bathrooms including unisex ADA
- Tenant-controlled central A/C, 11' open ceilings
- Wet pantry with granite counter tops; and stainless-steel appliances
- Polished concrete flooring in all open areas and black stallion carpeting in offices and conference rooms
- Sub-metered electric; FIOS and Spectrum Fiber. Fully pre-wired w/CAT 6 high-speed internet, telephone & data

Building Features

- Fully furnished, plug-and-play, move in condition
- Tenant – controlled central A/C, 11' high ceilings
- Sub – metered electric, FIOS & Spectrum Fiber, fully pre-wired w/CAT 6 high – speed internet, telephone & data
- 24 – hour/ 7 – day access
- Three state-of-the-art modernized passenger elevators
- Steps away from public transportation

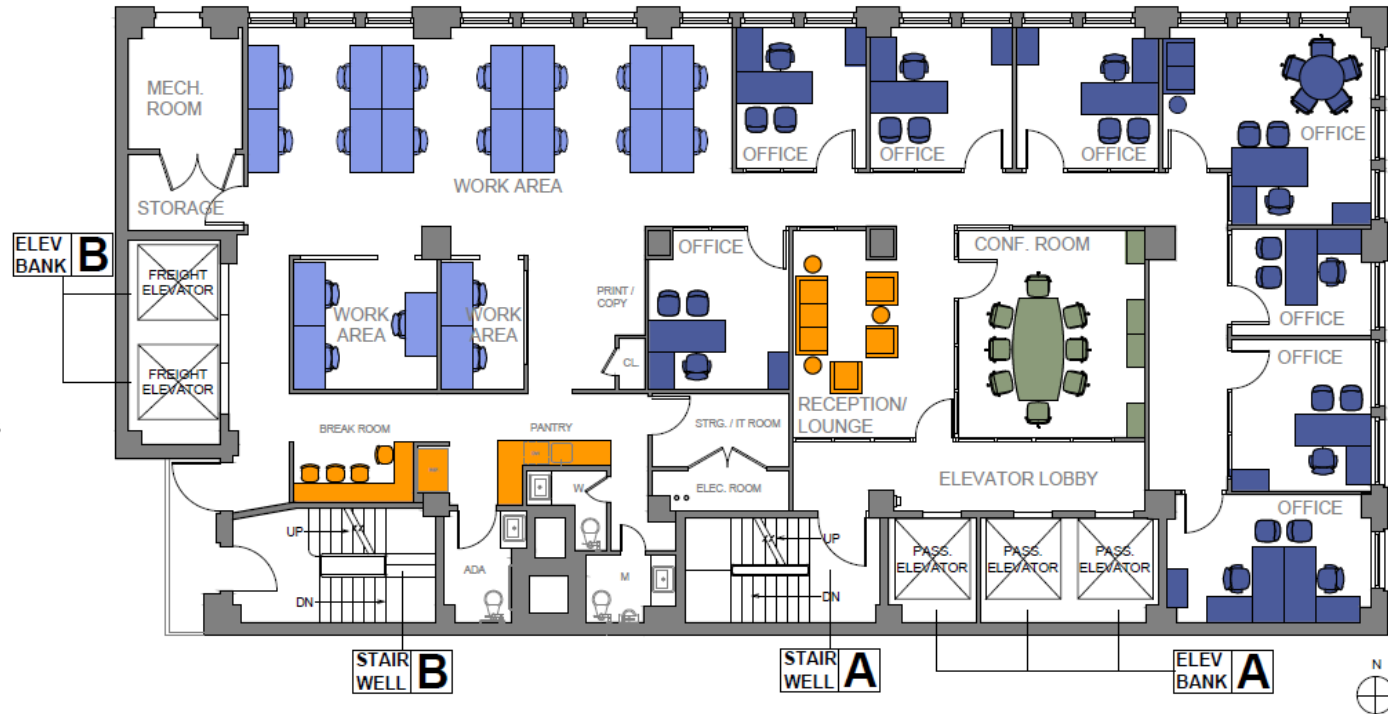

589 Eighth Avenue

8th Floor



589 Eighth Avenue

Suite	Approximate Size	Rent	Possession	Term
Entire 10 th Floor	5,200 RSF	Inquire	Immediate	Negotiable

Comments

- Eight (8) glass-fronted offices, glass-fronted conference/board room and open, windowed work area for up to sixteen (16) large workstations.
- Three (3) bathrooms including unisex ADA
- Wet pantry with granite counter tops, stainless steel appliances and adjacent break/seating area.
- Combination of polished concrete and black stallion carpeting, flooring.

Building Features

- Fully furnished, plug-and-play, move in condition
- Tenant – controlled central A/C, 11' high ceilings
- Sub – metered electric, FIOS & Spectrum Fiber, fully pre-wired w/CAT 6 high – speed internet, telephone & data
- 24 – hour/ 7 – day access
- Three state-of-the-art modernized passenger elevators
- Steps away from public transportation

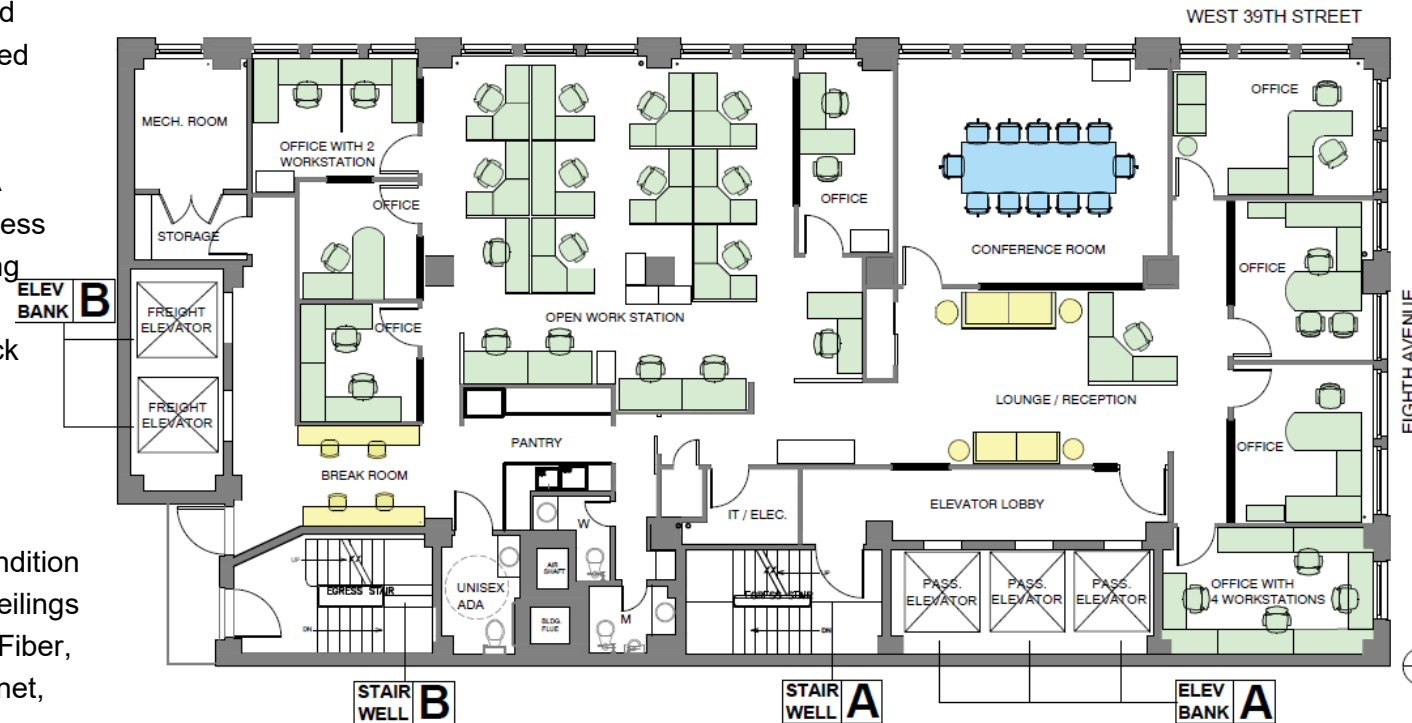

589 Eighth Avenue

10th Floor

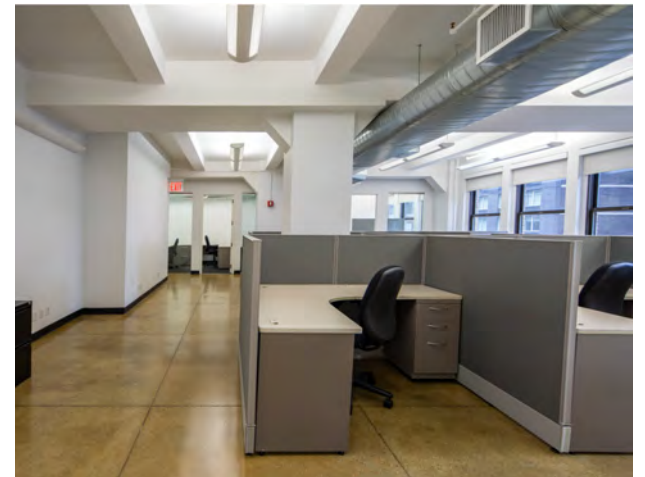

589 Eighth Avenue

Suite
Entire 23rd Floor

**Approximate
Size** 3,400 RSF

Rent
Inquire

Possession
Immediate

Term
Negotiable

Comments

- Duplex, Penthouse with private outdoor terrace
- Furnished, pre wired with CAT 6, plug and play opportunity
- Windowed glass fronted conference room, windowed glass fronted office and multiple open work areas
- Spiral staircase to PH conference room/lounge and outdoor terrace
- Wet pantry with stainless steel appliances
- Two (2) private, ADA bathrooms

Building Features

- Fully furnished, plug-and-play, move in condition
- Tenant – controlled central A/C, 11' high ceilings
- Sub – metered electric, FIOS & Spectrum Fiber, fully pre-wired w/CAT 6 high – speed internet, telephone & data
- 24 – hour/ 7 – day access
- Three state-of-the-art modernized passenger elevators
- Steps away from public transportation

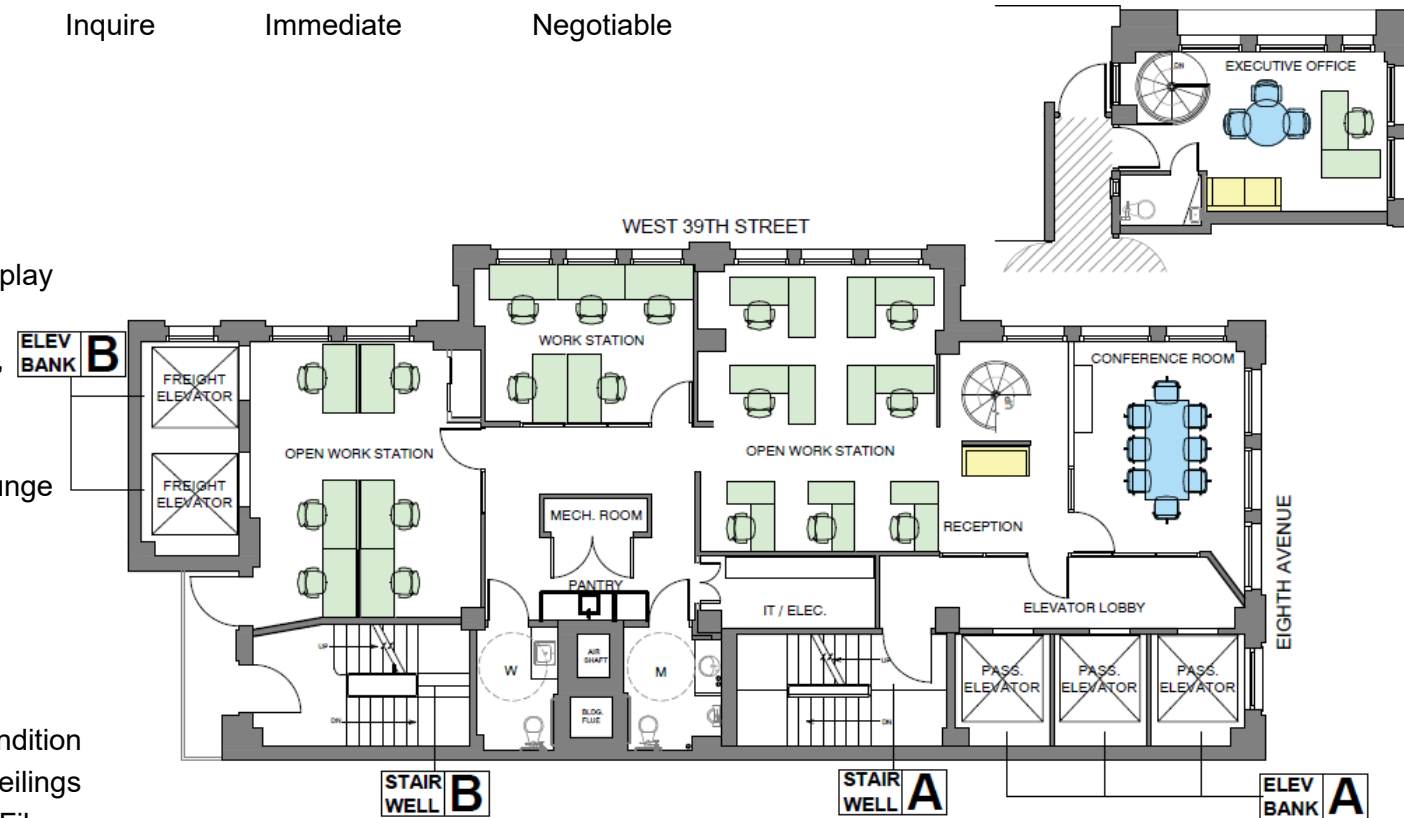

589 Eighth Avenue

23rd Floor



589 Eighth Avenue

