

# 215 Park Avenue South

Between 17<sup>th</sup> and 18<sup>th</sup> Street

---

SHORT-TERM FURNISHED  
SUBLEASE OPPORTUNITY

On Union Square Park



Express and Local Subway Lines



# Sublease term through June 2027

1,434 SQUARE FEET

Move-in ready, fully furnished corner unit with excellent natural light. Ideal for small, growing teams.



**PLUG-AND-PLAY UNION SQUARE OFFICE**

# As-built plan

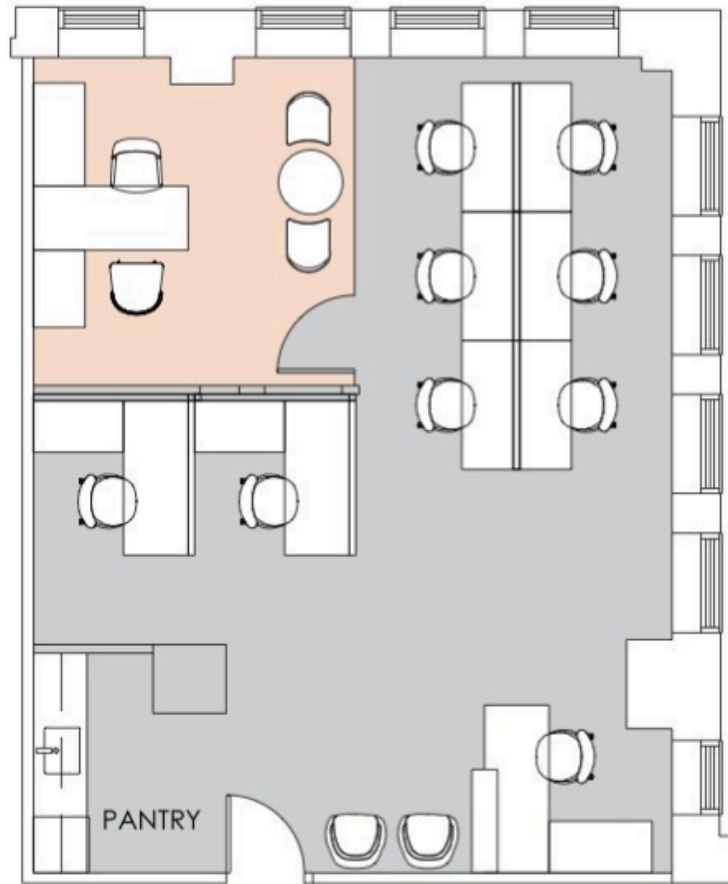

Built with 1 meeting room, a wet pantry and open area for 8-10 workstations.