

# 150

EAST 58TH STREET

Full-floor Sublease Opportunity  
within a Prestigious Address  
in the Plaza District





ENTIRE 39TH FLOOR

12,153 RSF

POSSESSION: Q4 2025

TERM: Through 03/30/2030

COMMENTS:

- Furnished and wired for immediate occupancy.
- Penthouse floor with unparalleled light and breathtaking, 360-degree views, including Central Park.
- Custom-designed interiors by MKDA, completed just a few years ago.

EXECUTIVE OFFICES	2
PRIVATE OFFICES	10
BENCHING (66"X30")	28
RECEPTION	1
CONFERENCE	4
MEETING	2
PANTRY	1
PHONE ROOM	1
COAT CLOSETS	2
COPY AREA	1
STORAGE	2
IT ROOM	1



LEXINGTON AVENUE

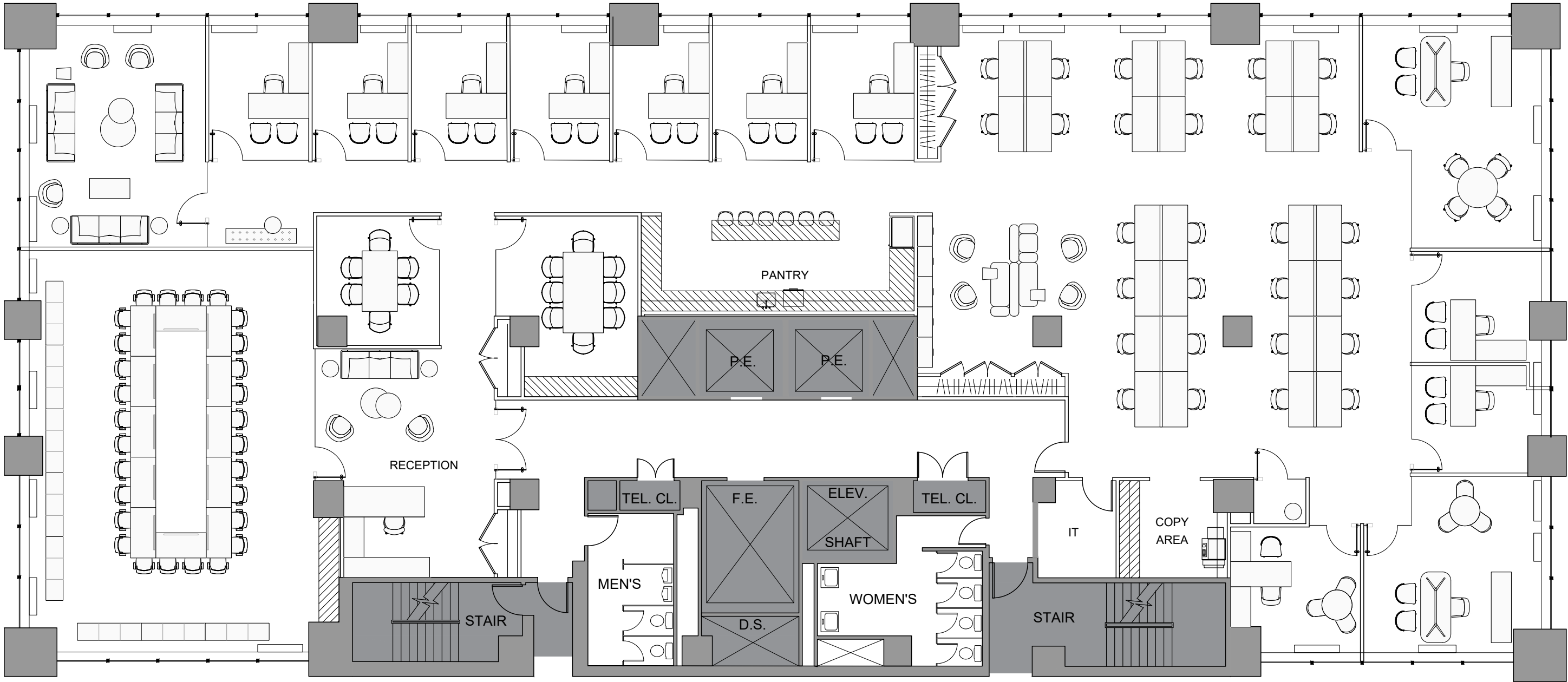







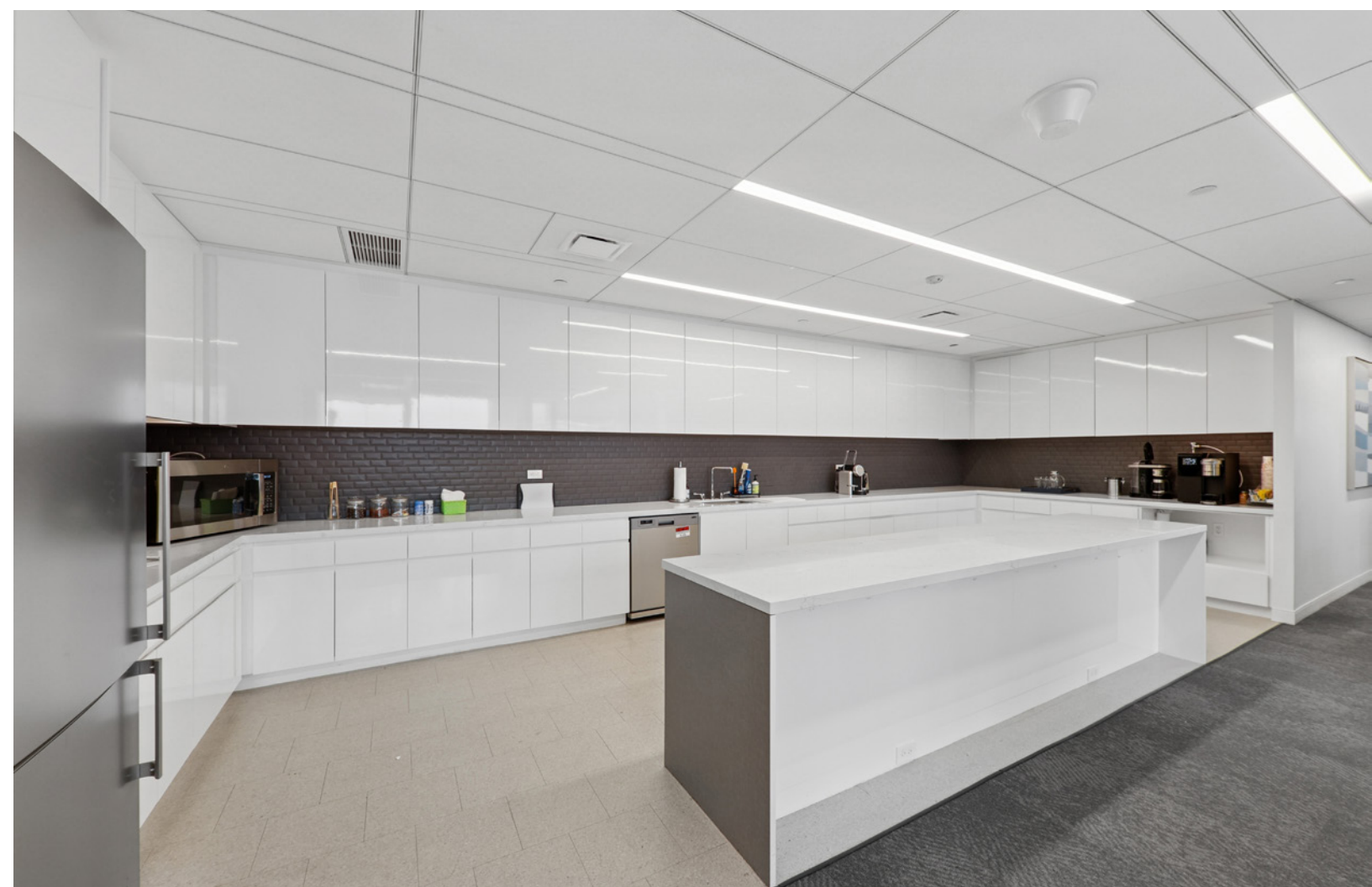



# 150

EAST 58TH STREET

