

# 33 E 33<sup>rd</sup> St.

Sublease Opportunity

Entire 2<sup>nd</sup>  
and 3<sup>rd</sup>  
Floors

(Can be Leased Individually)

26,582 RSF

Sublease Through May 2027 or

February 2030

Available July 2026

Entire 2<sup>nd</sup> Floor: 13,582 RSF

Entire 3<sup>rd</sup> Floor: 13,000 RSF



# 33 E 33<sup>rd</sup> St.

## Space Photos

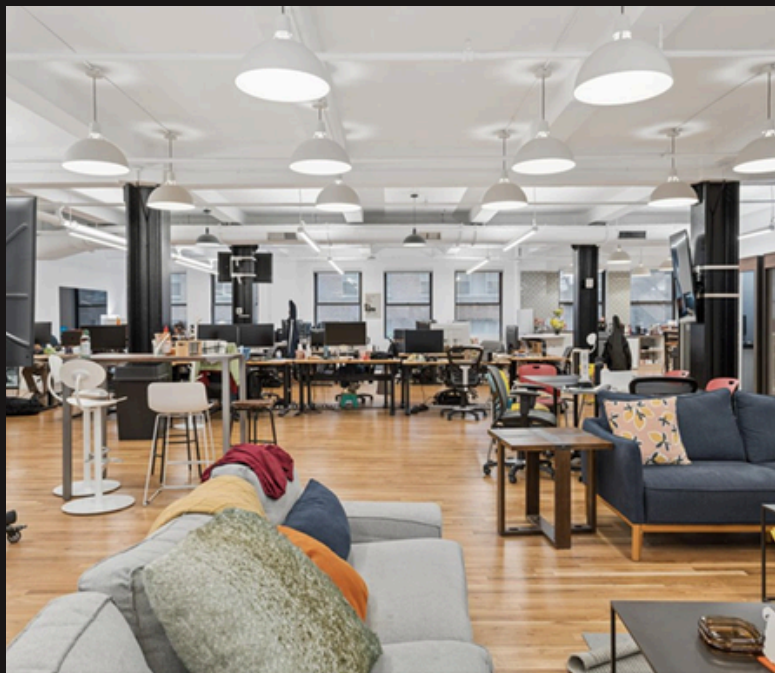

# 33 E 33<sup>rd</sup> St.

## Space Photos

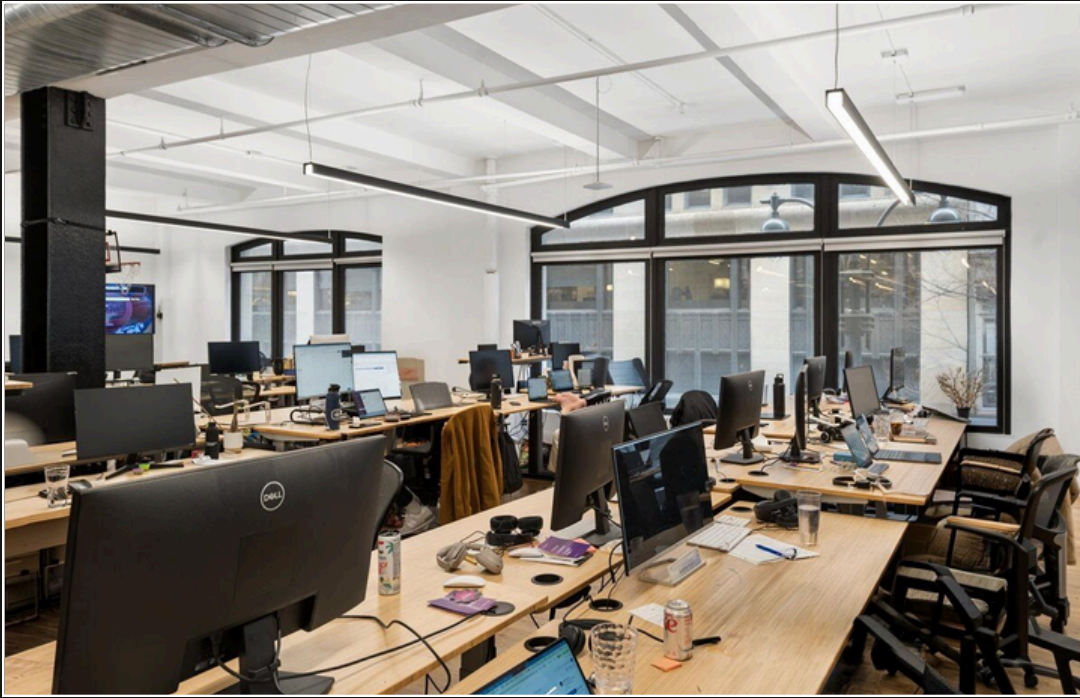

# 33 E 33<sup>rd</sup> St.

## Space Photos



# 33 E 33<sup>rd</sup> St.

## Floorplans\*

### 2<sup>nd</sup> Floor

- 80 Workstations
- 6 Offices / Meeting Rooms
- 2 Conference Rooms

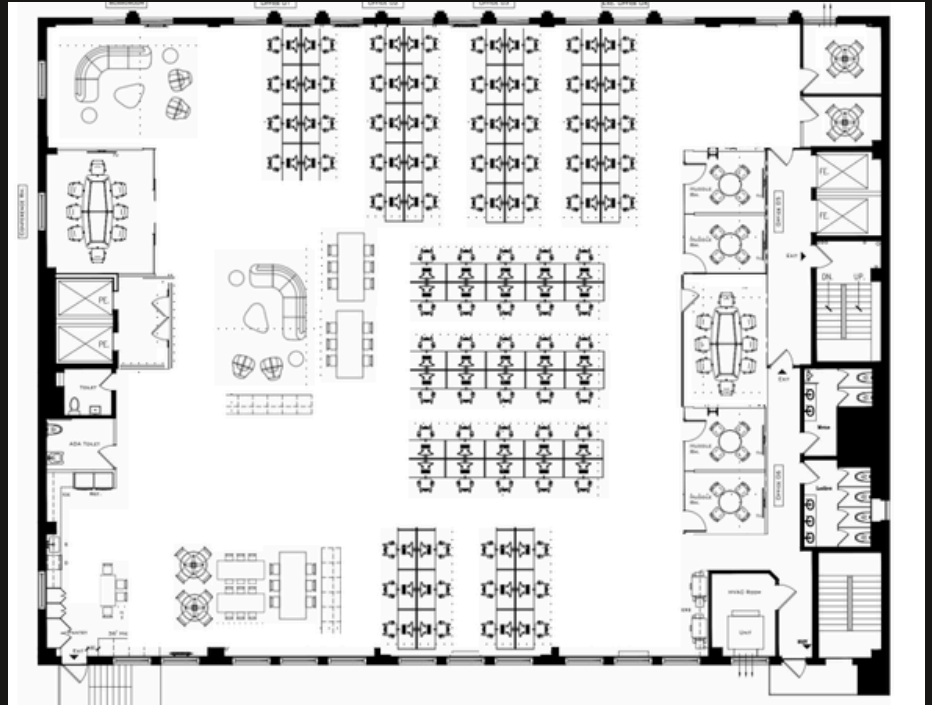

### 3<sup>rd</sup> Floor

- 80 Workstations
- 5 Offices / Meeting Rooms
- 2 Conference Rooms
- Gym

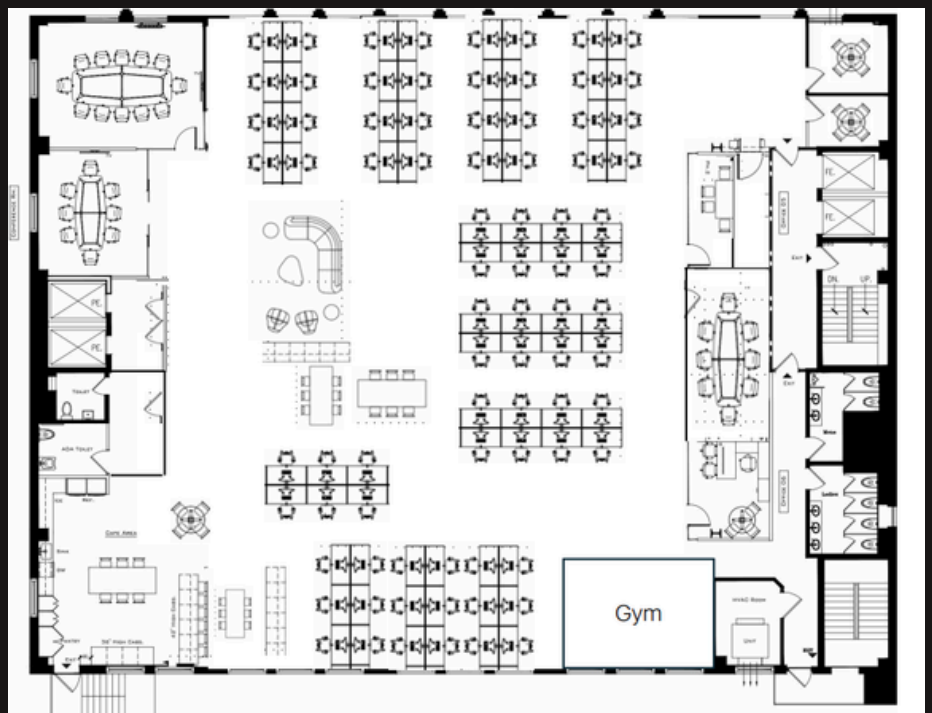

\*Floorplans are estimated. May not be to exact count & dimensions

# 33 E 33<sup>rd</sup> St.

## Building Photos

Renovated Lobby, 24/7 Concierge, Renovated Elevator Cabs, Card Access Security

