



425 Madison Avenue

Located on Southeast Corner of East 49th Street

Grand Central—
Plaza District Gem

Favorable Pricing



Building Lobby

Centrally Located Between Transportation Hubs at
Midtown's Bryant Park,
Grand Central Terminal
and Rockefeller Center



Entire 11th Floor



Entire 12th Floor

Available Space

Occupancy

Rent

Suite 700:	3,150 rsf - Multiple offices, corner executive office - Conference/meeting room, reception area, and wet pantry	Immediate	Upon Request
------------	---	-----------	--------------

Highlights

- Boutique office building in central Midtown East location; 24/7 beautifully appointed and attended lobby
- Two blocks from 47th Street entrance to Grand Central Madison LIRR Concourse with seamless connection to Grand Central Terminal; and close proximity to Rockefeller Center and Bryant Park transportation hubs

7TH FLOOR - SUITE 700 / SUITE 701 - CAN BE COMBINED TO CREATE 3,950 RSF
(AS-BUILT)

MADISON AVENUE

EAST 49TH STREET

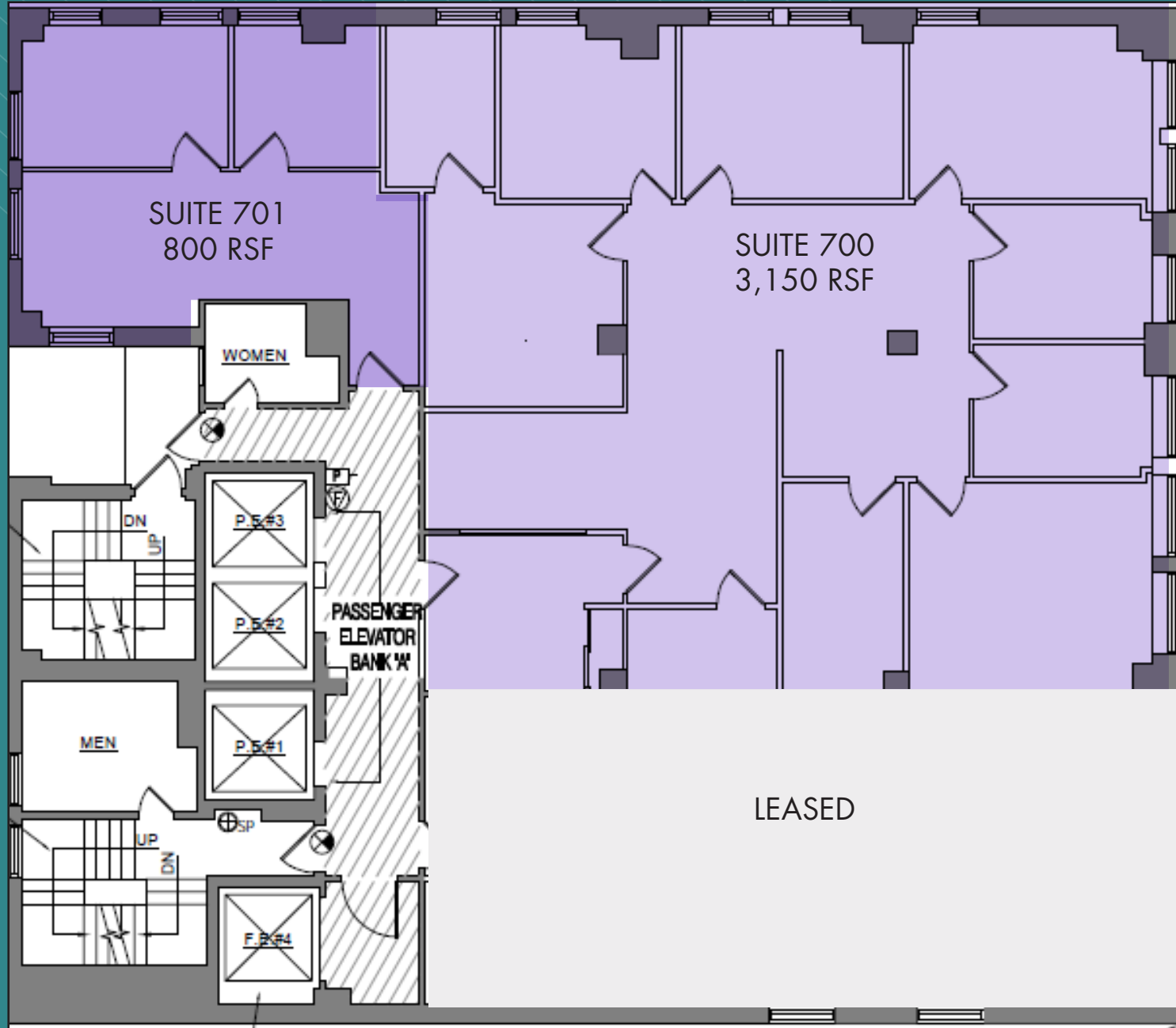

(Floor plan for descriptive purposes only; not to scale.)

SUITE 700 - 3,150 RSF
(EXISTING CONDITIONS)



SUITE 700 - 3,150 RSF DIVISION
(EXISTING CONDITIONS)



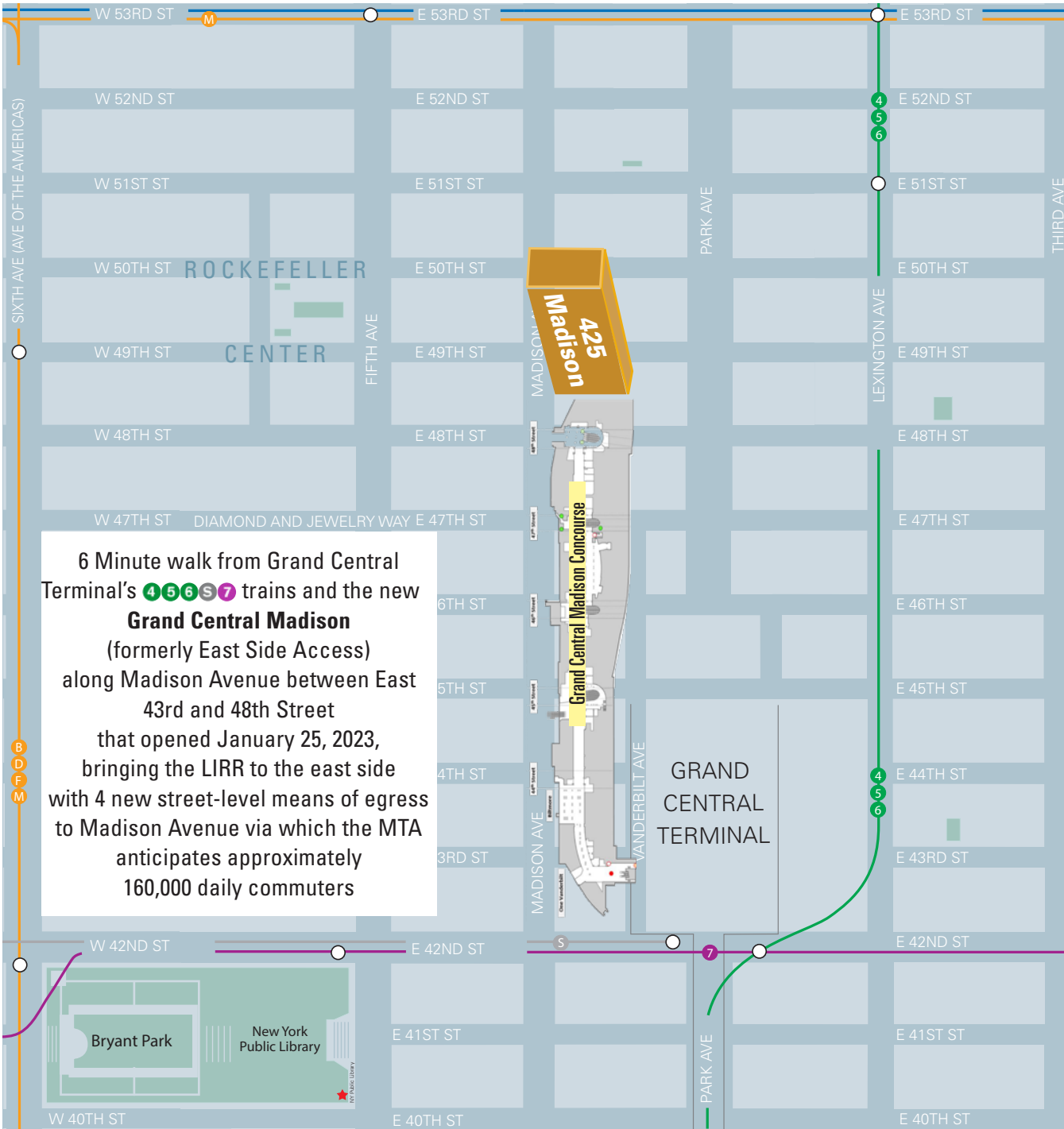

Rockefeller Center

