



153 WEST 27TH STREET



FLEX BY NOMAD





FLOOR PLAN

153 WEST 27TH STREET

BETWEEN SIXTH & SEVENTH AVENUES

PARTIAL 12TH FLOOR / PENTHOUSE

3,493 SF

OPEN SEATING

WORKSTATIONS: 20+
RECEPTION AREA: 1

COLLABORATION SPACE

OFFICE/MEETING ROOMS: 4
OFFICE / MEETING ROOMS: 1

SUPPORT

WET PANTRY: 1
PHONEBOOTH: 2 (MODULAR PHONE BOOTHS IN PLACE)

DESCRIPTION

- Fully Furnished & Wired Space
- Kisi Access Control Installed
- Ceiling Tile / Carpet Tile Sound mitigation installed
- Blinds installed on all southern windows
- Amazing Natural Light on the top floor – no southern obstruction
- Brand new restrooms on the 12th floor!

\$18,000 / MONTH

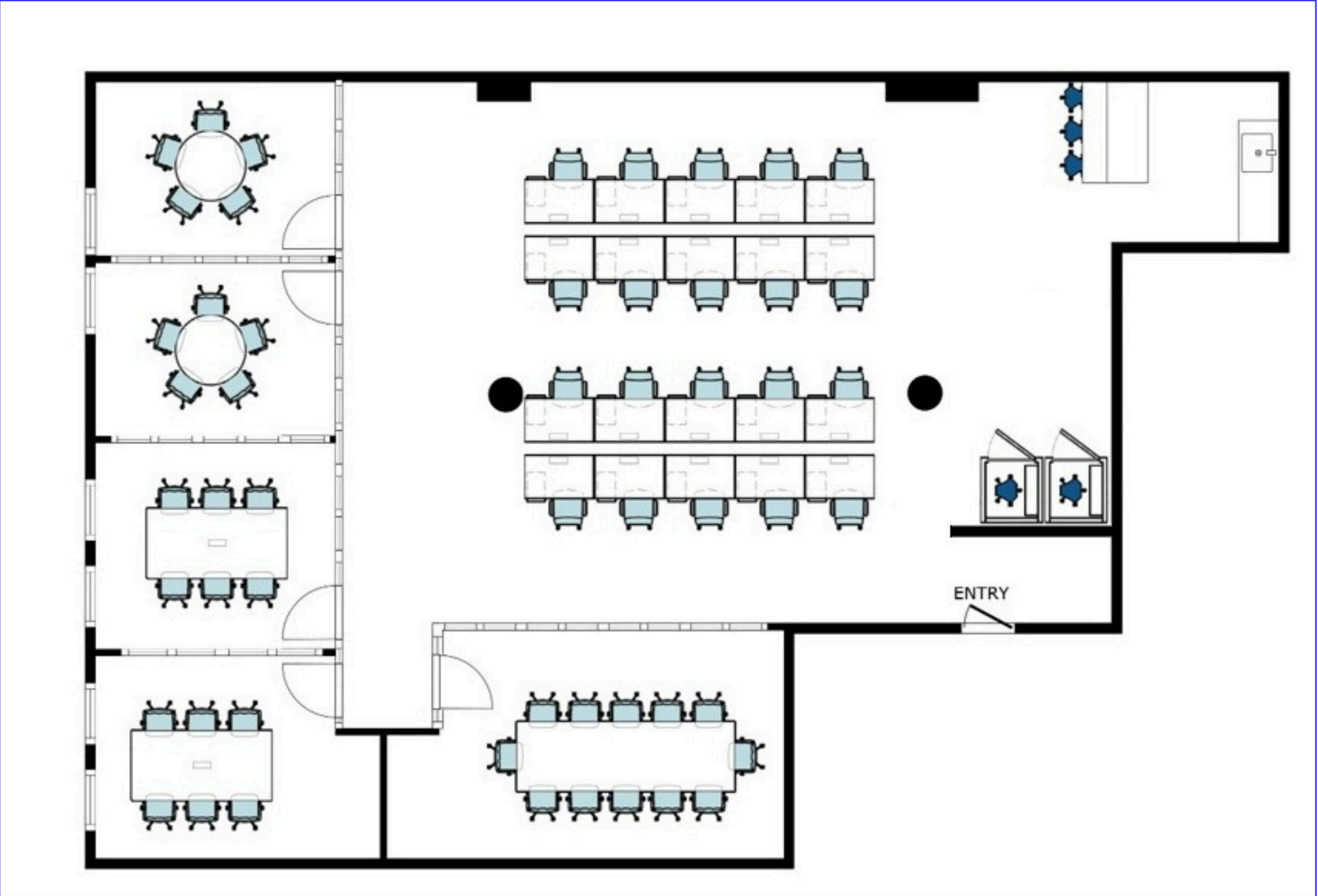

153 WEST 27TH STREET

153 West 27th Street is a classic prewar loft building located in the heart of Chelsea, just steps from Penn Station, FIT, and Madison Square Garden. The property features full-floor suites with high ceilings, exposed brick, and oversized windows that bring in excellent natural light. Ideal for creative, media, fashion, and professional users, the building offers flexible floor plates, direct elevator access, and a boutique feel with just a handful of tenants. With close proximity to the 1, N, R, F, M, and PATH trains, and surrounded by dining, retail, and cultural institutions, 153 West 27th Street provides a well-connected, character-rich workspace in one of Manhattan's most vibrant submarkets.

