

1370 Avenue of the Americas New York, NY

Continental Tower Sublease Available



Property Overview



AVAILABLE SUITE
Suites 1001/1002
6,204 SF



SUBLEASE RATE/RSF
Negotiable



TIMING
Immediately



SUBLEASE EXPIRATION
5/31/31



BUILDING SIZE
347,000 SF
35 Stories



Class A
Office Space



PROPERTY DETAILS

Unit(s) are in pristine, move-in ready condition, Excellent natural light, 10-foot ceilings, Great window exposure, Existing furniture available



1370 Avenue of the Americas New York, NY

Suite Details:

1002:

- (1) pantry / open collaboration
- (1) conference / meeting room
- (1) office
- (20) 30"x60" workstations
- (2) phone rooms

Building Amenities

- 24 Hour Access
- Banking
- Property Manager on Site

COMBINED
6,204 RSF

SUITE 1002
3,543 RSF

SUITE 1001
2,661 RSF

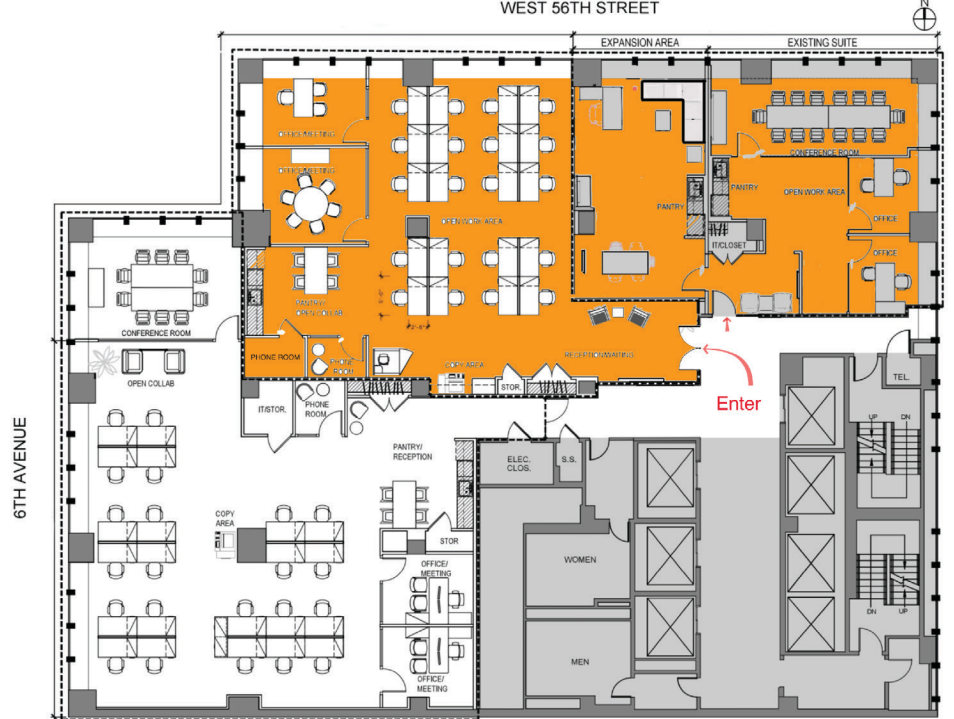

1370 Avenue of the Americas New York, NY

