

24 UNION
SQUARE
EAST

URBAN APPAREL

URBAN APPAREL

Conceptual Rendering

HIGH-TRAFFIC RETAIL OPPORTUNITY
ACROSS FROM UNION SQUARE PARK

24 UNION SQUARE EAST

24 UNION SQUARE EAST
Between 15th & 16th Streets

APPROXIMATE SIZE

Ground Floor: 9,932 SF

Lower Level: 9,322 SF

APPROXIMATE CEILING HEIGHTS

Ground Floor: 17'2"

Lower Level: 10'

COMMENTS

Direct access to loading dock from East 16th Street.

Next door to the Daryl Roth Theater.

Situated in front of the Union Square subway, one of the busiest stations in all of NYC.

Great signage and visibility with double-height storefront.

Divisions considered.

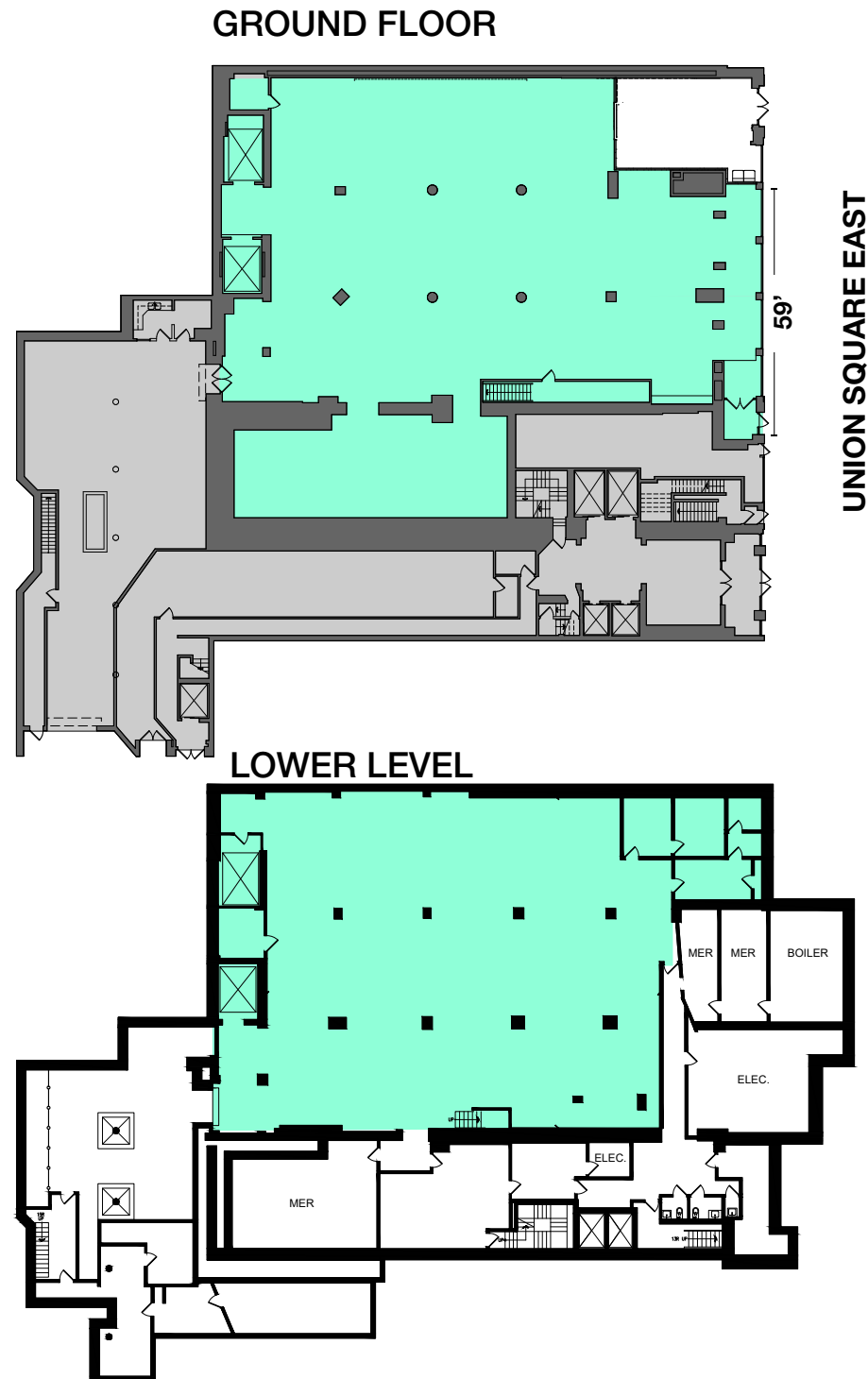

24 UNION SQUARE EAST

PROPOSED GROUND FLOOR DIVISIONS

