

---

# 243 CANAL STREET

*Incredible Full Floors with Premium Finishes and High Ceilings*

---



# 243 CANAL STREET

ESTATE ADVISORS  
COMMERCIAL REAL ESTATE

**Entire 2nd floor - 4,950 RSF**  
**Entire 4th floor - 4,950 RSF**

## Features

- Landlord will Provide a New Turnkey Installation
- Newly Renovated Building
- Polished Concrete Floors, Exposed Brick and Vaulted Ceilings
- 24/7 access
- Direct access to Canal Street Subway lines

6 J M Q R W Z

# 243 CANAL STREET

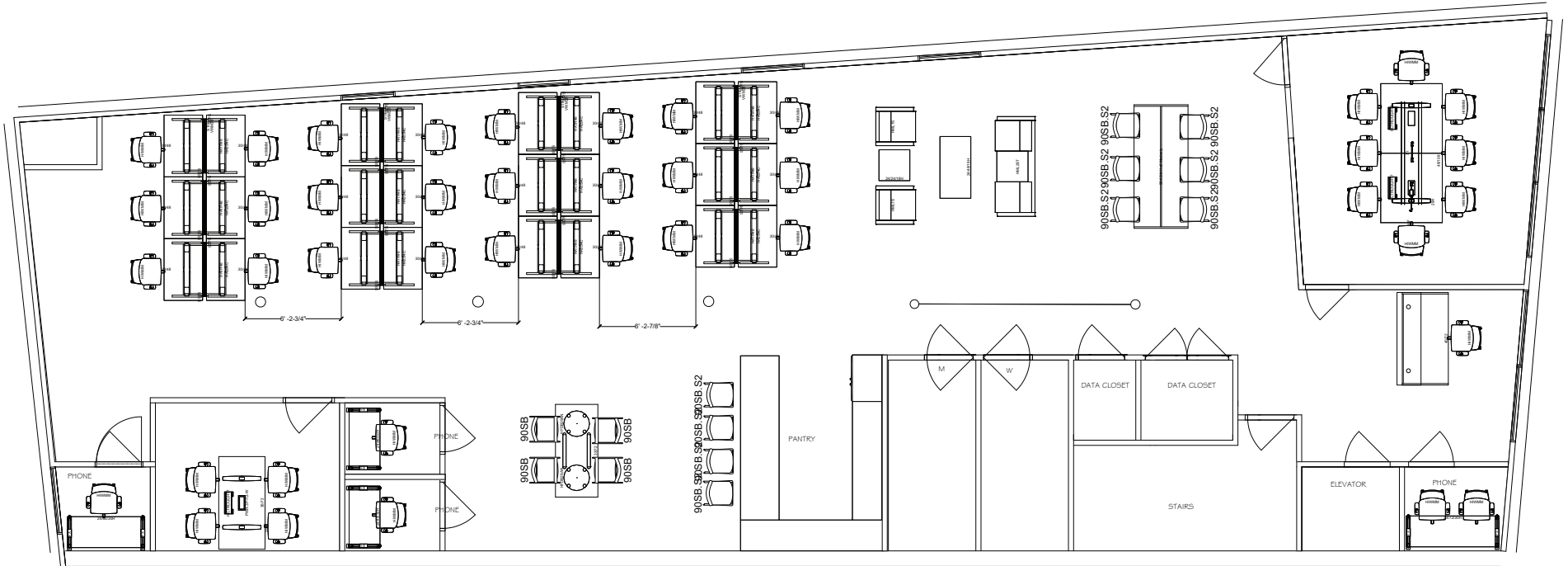

LSL ADVISORS  
COMMERCIAL REAL ESTATE

# 243 CANAL STREET



---

# 243 CANAL STREET

---

