

For Sublease

810 Seventh Avenue

Between 52nd and 53rd streets

Space Features

- Fully furnished – ready to move in
- 7 private offices
- 1 large conference room
- Pantry
- Open area with 28 workstations
(floorplan shows representative furniture plan)
- Views overlooking Central Park

Building Features

- Conference center
- 200-car garage located in building
- Direct access to on-site parking garage

Central Park

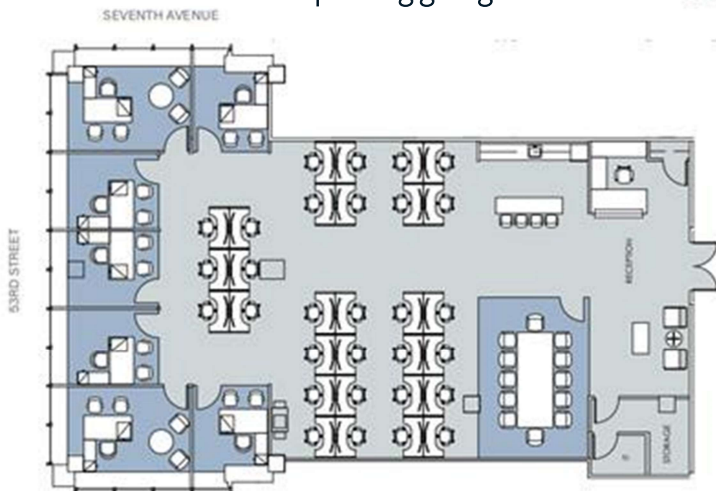

Space Details

Space: Partial 22nd Floor

Area: 5,970 RSF

Term: May 30, 2029

Possession: Immediate

For Sublease

810 Seventh Avenue – Partial 22nd Floor – 5,970

RSF

