



## OFFICE SUBLEASE AVAILABLE

N/E/C of West 39th Street  
1412 Broadway | NY

### SUBLEASE OVERVIEW

|                       |                   |
|-----------------------|-------------------|
| RATE:                 | Call for Details  |
| PREMISES:             | Partial 4th floor |
| SQUARE FOOTAGE:       | 6,109 SF          |
| SUBLEASE THROUGH:     | 12/31/2026        |
| AVAILABILITY:         | Immediate         |
| YEAR BUILT/RENOVATED: | 1926/2014         |



### BUILDING NOTES

The building features on-site security, concierge services, modern elevators, an upscale on-site restaurant, and a rooftop deck offering breathtaking city views.

Just steps away from iconic landmarks such as Times Square and Bryant Park, and within a short walk of major transportation hubs like Port Authority, Penn Station and Grand Central Terminal, 1412 Broadway provides unmatched accessibility and prestige for businesses seeking a prime Manhattan address.

### SPACE NOTES

- 8 private offices, 12 workstations, a large conference room, a dedicated meeting room, and an eat-in pantry
- Fully furnished, equipped, and professionally wired for seamless operations
- Views of Broadway
- Natural light throughout the space

1412 Broadway  
New York, NY 10018



AMENITY  
MAP

# 1412 Broadway

New York, NY 10018

PARTIAL 4TH FLOOR: 6,109 SF

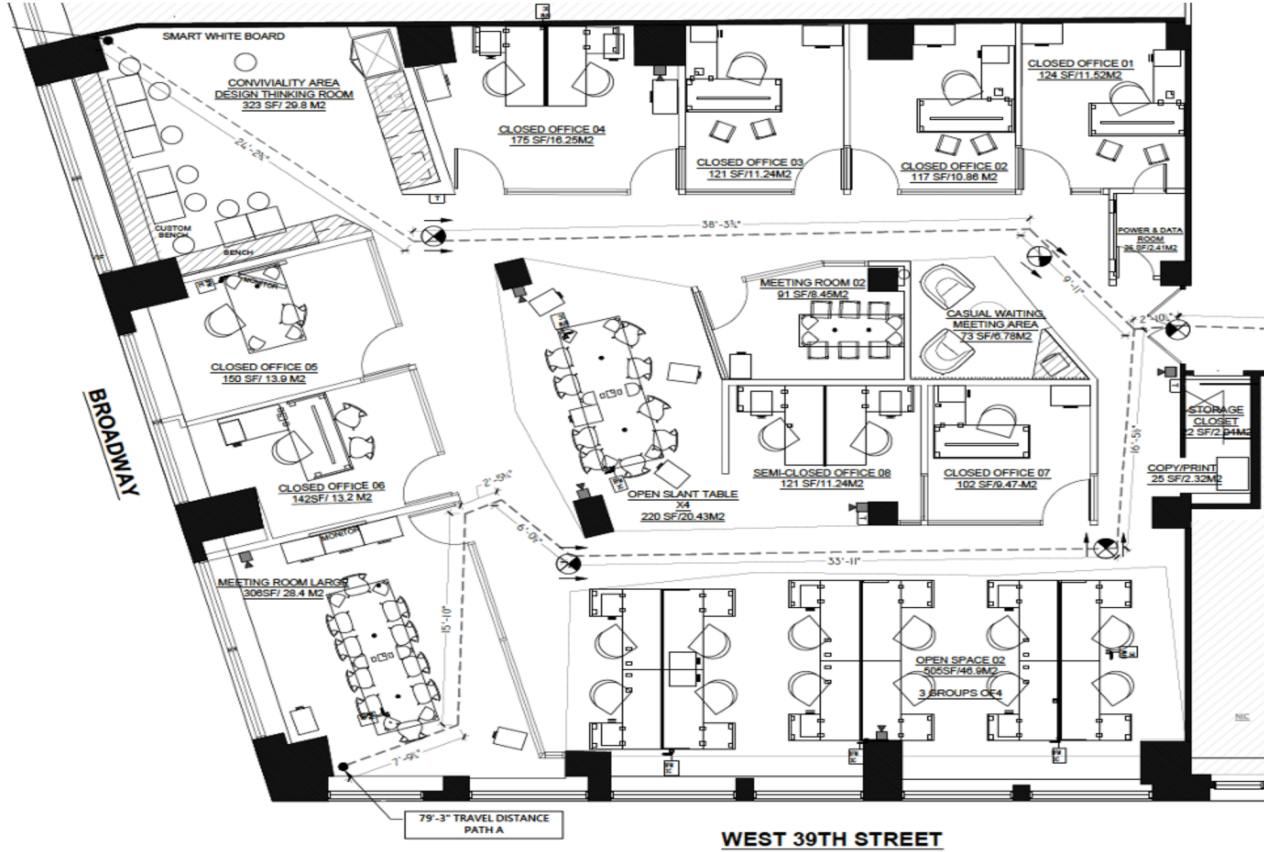

# 1412 Broadway New York, NY 10018

