



530  
Fifth  
Avenue

7,803 RSF  
Sublease

# Entire 21

Size: 7,803 RSF

Possession: Immediate

Term: Through July 2028

- Furniture available
- Building is proximate to multiple transportation options and is within walking distance of Grand Central, Times Square, Port Authority, Bryant Park, and Rockefeller Center.
- Layout includes a mix of offices, conference rooms, and open area for employee seating.

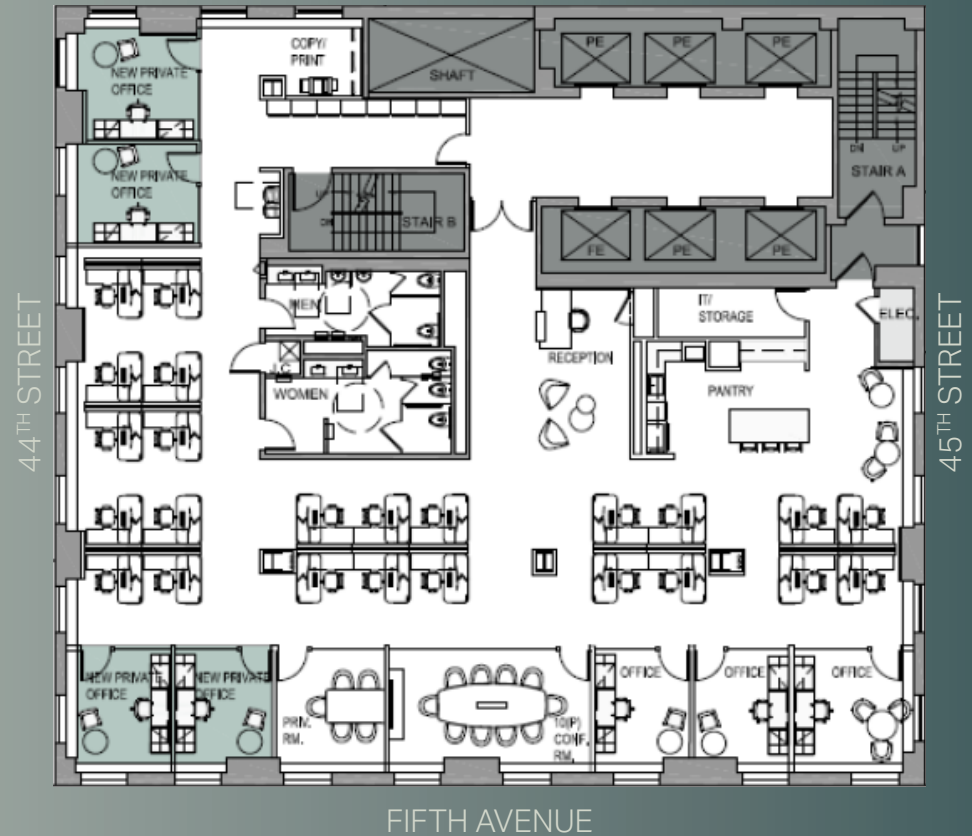



# 530 Fifth Avenue

Actual View

