

# Class A, Turn-Key Office Condominium For Lease - International Gem Tower

50 West 47th Street - New York, NY 10036

Prime Midtown location between Fifth and Sixth Avenues

**Approximate Size:** RSF 2,200

**Suite Number:** 20Th floor

**Floor:** 20th

**Possession:** Immediate

**Term:** Negotiable

**Asking Price:** Upon Request

## Unit Highlights

Turn-Key office  
Luxury High-end finishes  
Unobstructed East views  
Fantastic natural light  
Floor-to-ceiling windows  
Six private office rooms  
Full Kitchen  
Conference Room  
Reception Area  
Waiting Room  
Security Mantrap

## Building Highlights

State of the art vault facility  
Secure valet parking  
Ultra modern infrastructure  
Luxurious fitness center  
LEED certified  
Biometric access control  
G4S guarding services  
Closed-circuit monitoring



**Class A, Turn-Key Office Condominium  
For Lease - International Gem Tower  
50 West 47th Street - New York, NY 10036  
Prime Midtown location between Fifth and Sixth Avenues**





**Class A, Turn-Key Office Condominium  
For Lease - International Gem Tower  
50 West 47th Street - New York, NY 10036  
Prime Midtown location between Fifth and Sixth Avenues**



## Prime Midtown location between Fifth and Sixth Avenues

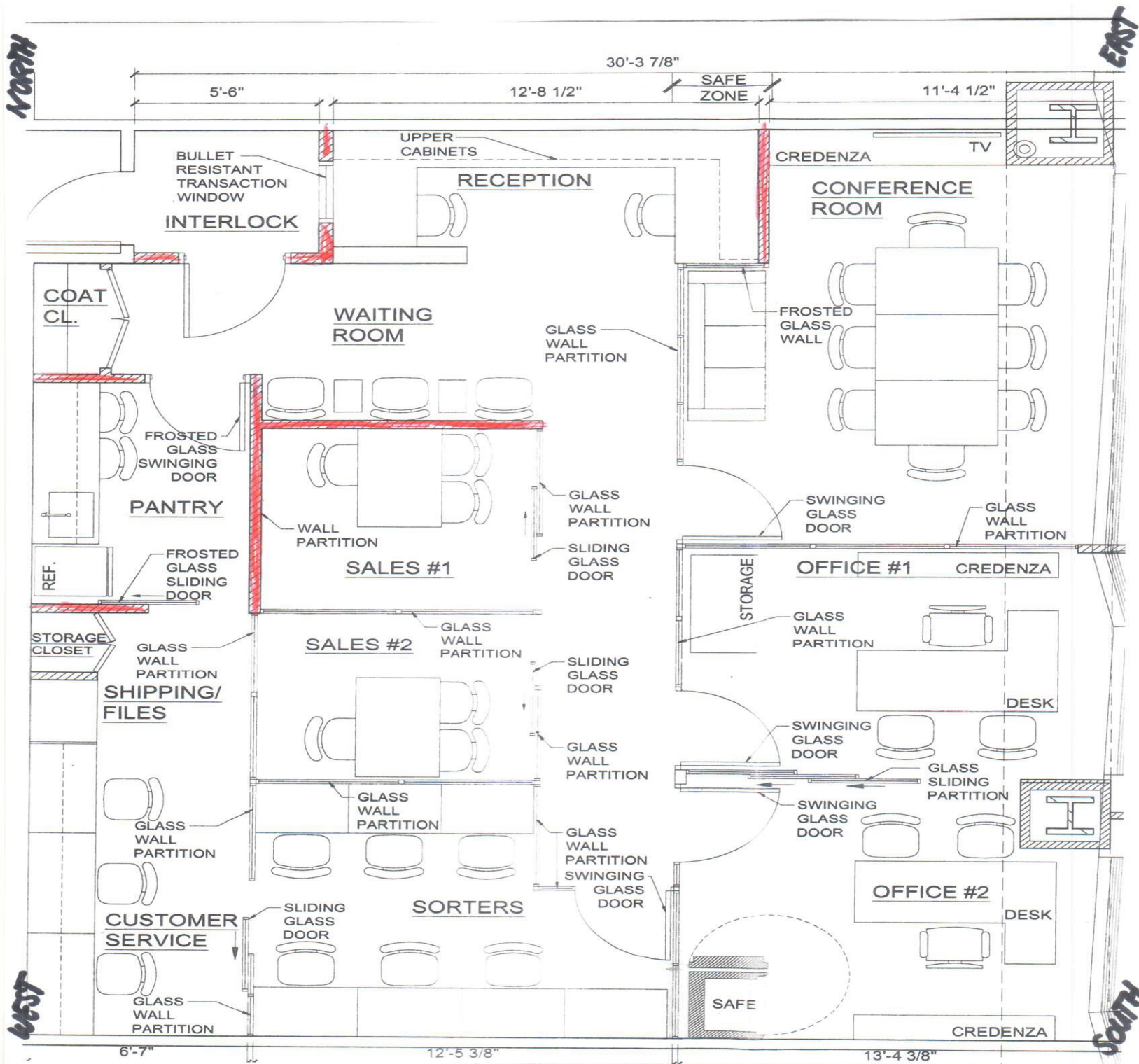



# Class A, Turn-Key Office Condominium For Lease - International Gem Tower

50 West 47th Street - New York, NY 10036

Prime Midtown location between Fifth and Sixth Avenues

