

---

# 277 Mott Street

NOLITA  
NEW YORK, NY



277 MOTT STREET

# Property Details

## Location

Between East Houston and Prince Streets

## Approximate Size

Ground Floor	1,100 RSF
Lower Level	1,849 RSF
Second Floor	1,100 RSF
Third Floor	1,100 RSF
Fourth Floor	1,100 RSF
Fifth Floor	1,100 RSF
Sixth Floor	1,100 RSF
Seventh Floor	900 RSF
Total	9,349 RSF

## Term

Long term or "Pop Up"

## Possession

Immediate

## Site Status

New Construction

## Comments

9,349 RSF across eight levels to be leased by single tenant on a short term "Pop Up" or long term basis

Magnificent structure designed by acclaimed architect Toshiko Mori

The twisting front facade creates a presence that appears to shift from opaque to transparent

A transparent rear facade highlights a monumental stair which serves as a primary means of vertical circulation visible from Mulberry Street

Building features backyard garden plus roof top deck

All floors serviced by a large elevator. ADA restrooms on three levels

All uses considered

Single tenant building, column free

## Ground Floor

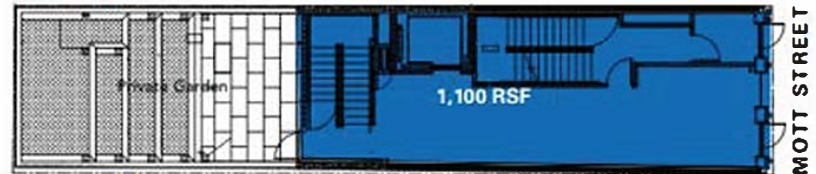

## Lower Level



## Second, Fourth and Fifth Floors

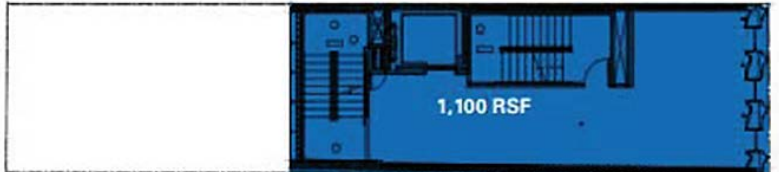

## Third and Sixth Floors

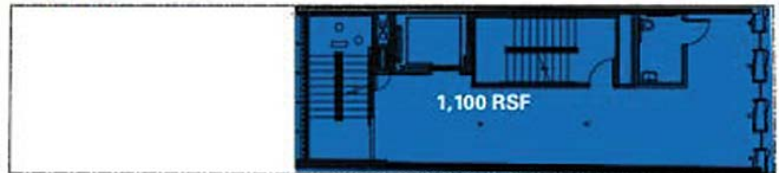

## Seventh Floor



## 277 MOTT STREET



COMING SOON