

For Sublease

1 Penn Plaza
New York, NY

Brand New Sublease!

Partial 47th Floor: 1,961 rsf

Term: Through January 31st, 2025

- Recently built, high end instillation with amazing light and views
- Fully furnished, Move-in ready space
- Glass Enclosed Offices and Pantry
- Strong Sub-Lessor
- Direct Extension Possible

Office Layout

- 3 Offices
- 1 Conference Room
- File Room
- Pantry
- Reception

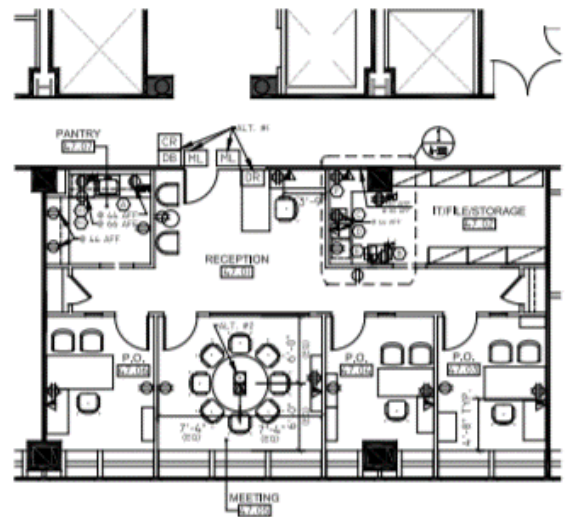

33rd Street