



712 FIFTH AVENUE

Entire 14th Floor - 12,930 RSF

**PLUG & PLAY
PLAZA DISTRICT
FULL FLOOR SUBLEASE**



712 FIFTH AVENUE

FLOOR/AREA: Entire 14th - 12,930 RSF

TERM: Through June 2026

POSSESSION: Immediate

ASKING RENT: Upon Request

COMMENTS:

- High-end installation delivered fully furnished and wired
- Features private offices / break-out rooms, conference rooms, open area, and multiple collaborative rooms
- Abundance of natural light with 4 sides of windows
- High quality sublandlord
- Building recently completed a capital improvement program (i.e. renovated lobby & elevator cabs)

712 FIFTH AVENUE

EXISTING CONDITIONS



712 FIFTH AVENUE

FLOOR PLAN

Entire 14th Floor - 12,930 RSF

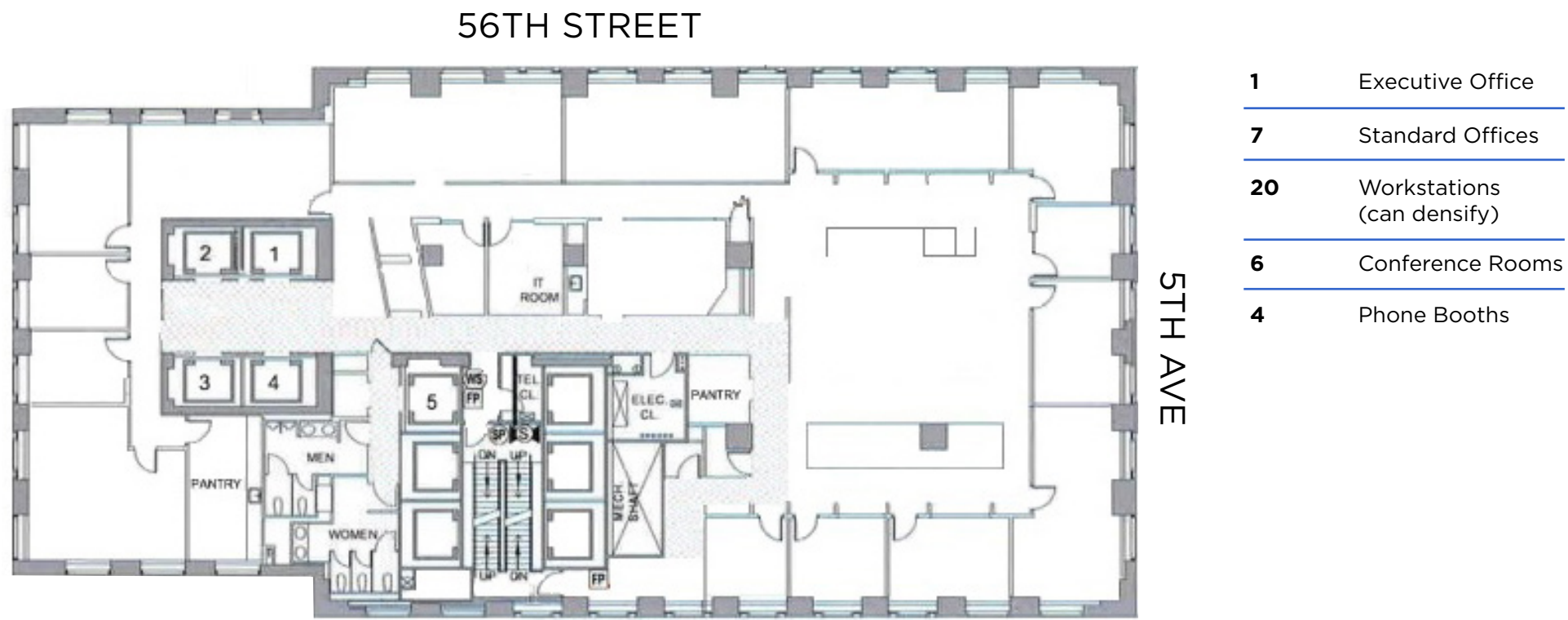



712 FIFTH AVENUE