

500

FIFTH AVENUE

15TH FLOOR | 13,157 RSF
PRIVATE OUTDOOR SPACE
BRYANT PARK VIEWS



PARTIAL 15TH FLOOR PLUG N' PLAY SPACE

13,157 RSF

Divisible to 2,910 RSF

- Pristine Above-Standard Installation
- Private Outdoor Space
- Triple-Corner Unit along Fifth Avenue
- Views overlooking Bryant Park
- Collaborative Spaces, Kitchenette
- Glass walled offices and conference rooms





BRIGHT SPACE WITH
MIX OF OFFICES AND
OPEN AREA



43RD STREET

PARTIAL 15TH FLOOR 13,157 RSF

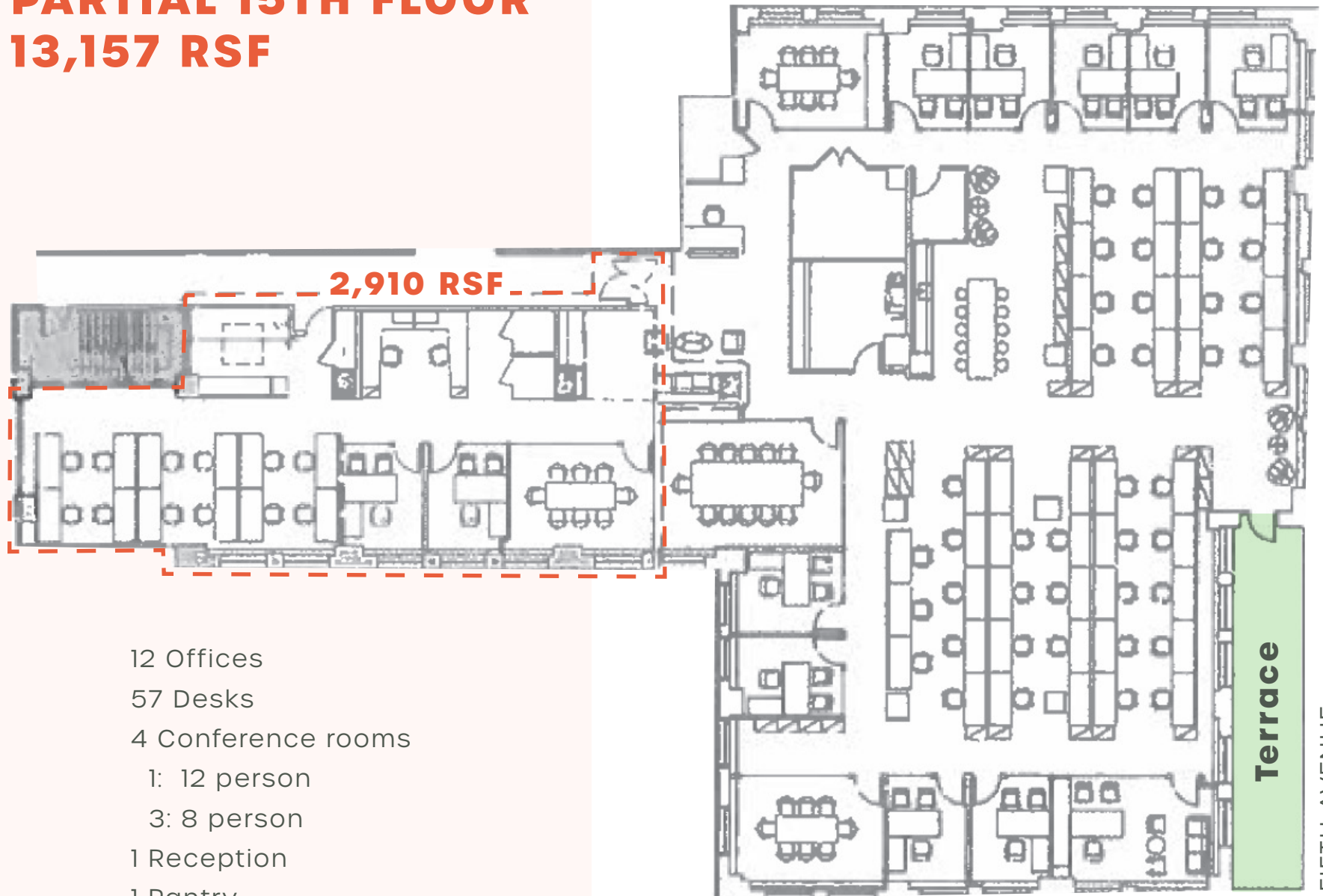

- 12 Offices
- 57 Desks
- 4 Conference rooms
 - 1: 12 person
 - 3: 8 person
- 1 Reception
- 1 Pantry
- 1 Terrace

42ND STREET

FIFTH AVENUE

500

FIFTH AVENUE

