



**NEW SUBLEASE AT
ONE GRAND CENTRAL PLACE**

60 EAST
42ND STREET



P.14

(Suite 1440)

RSF

15,675

POSSESSION

Immediate

TERM

12/30/2029

(will consider shorter term)

COMMENTS

- Move in condition space, fully furnished and wired.
- Recently built featuring 3 conference rooms, 16 offices and 90+ workstations.
- Centrally located building, directly across the street from Grand Central Terminal (with in-building access to GCT) and a close walk to Bryant Park.
- Tenant only conference center amenity in the lobby of the building.



Partial 14th Floor - Suite 1440
15,675 RSF

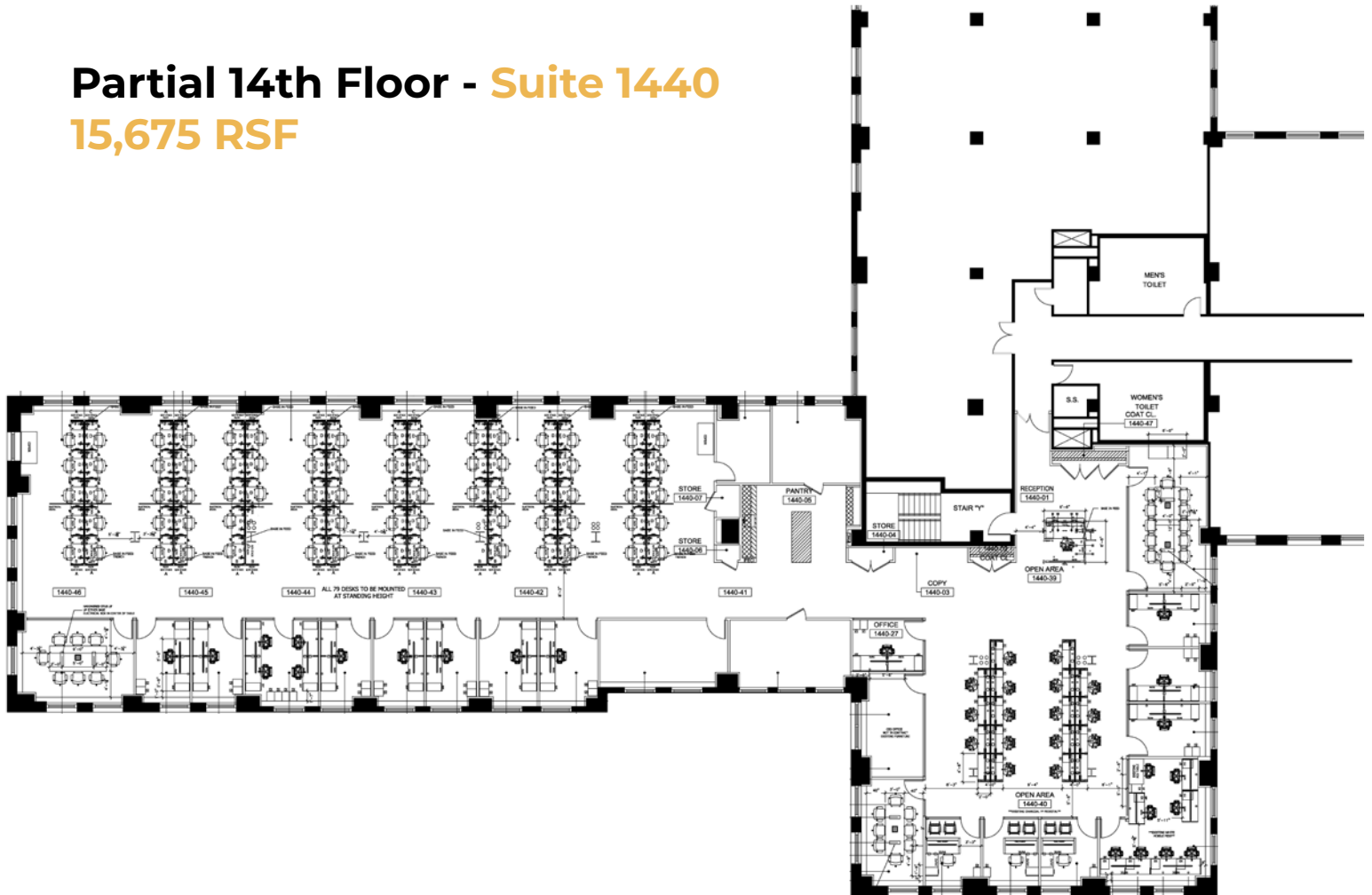

ONE GRAND CENTRAL PLACE

60 EAST
42ND STREET