



1700 BROADWAY

Entire 7th Floor – **23,697 RSF**

~~Possession: Immediate~~

Sublease Term: **Through October 30, 2028**

Institutional Sublandlord

SPACE FEATURES

ENTIRE 7TH FLOOR - 23,697 RSF

- Full Floor Presence
- Fully furnished, wired, plug and play installation with a mixture of open, office and collaboration space
- Installation features:

30 Offices | **3** Conference Rooms

74 Workstations | **1** Studio | **1** Pantry

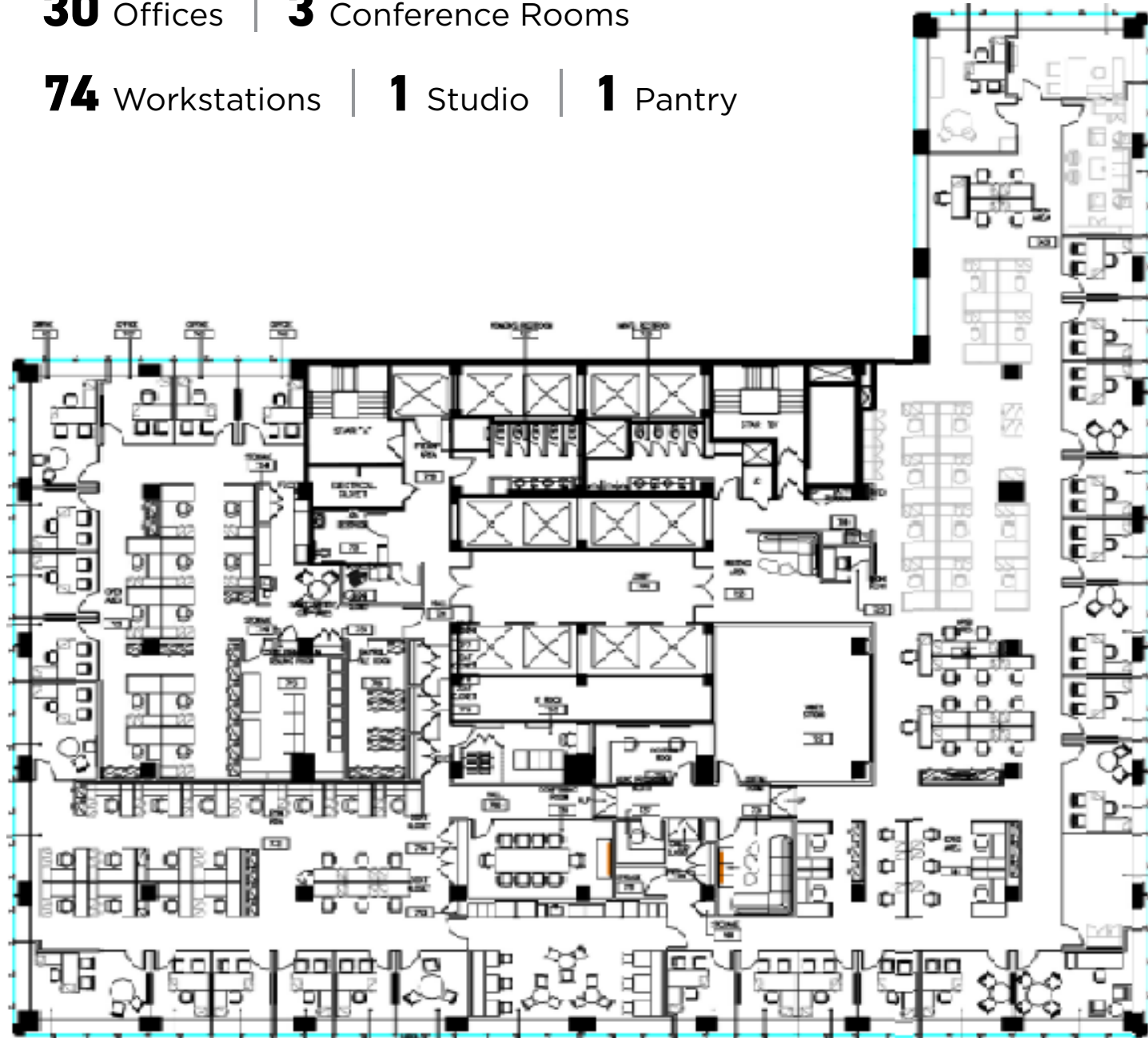

BROADWAY



BUILDING FEATURES

- New lobby
- New elevators, featuring destination dispatch
- Full service on-site parking garage
- Extended base building HVAC: 8:00 AM through 6:00 PM Monday - Friday and 9:00 AM - 1:00 PM Saturday
- Stunning tenant amenity center, 1700 Broadway Club, featuring:

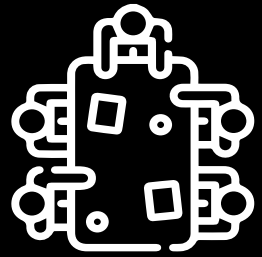

Conference Center / Meeting Rooms

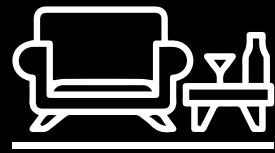

Tenant Lounge

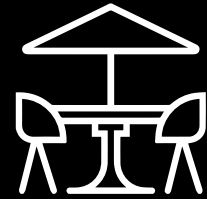

2,000 SF Terrace



Quiet Workspaces

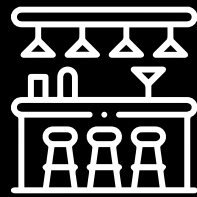

Bar



Fitness Studio

1700 BROADWAY CLUB



EXCLUSIVE 2,000 SF TERRACE



TRANSPORTATION & AMENITY MAP



9 Mins to Penn Station

7 Mins to Port Authority

13 Mins to Grand Central

5 Blocks to Central Park



KEY

● RESTAURANTS

● HOTELS

● CITI BIKE

