

# BRAND NEW PREBUILT IN THE CENTER OF IT ALL



## Space Profile

Size: **26,054 SF**

Floor: **Entire 23rd**

Rate: **Please Inquire**

Availability: **Immediate**

Term: **Through December 2026**

## Key Highlights

- Brand new prebuilt with 10 meeting rooms/ office, open area for 190+, 2 pantries, and 2 private showers
- Steps to Bryant Park, Times Square, and the Broadway pedestrian plaza
- Tenant amenity center on the lobby floor



**SUBLEASE** 1400 Broadway, New York, NY 10018 | Penn Plaza/Garment Submarket

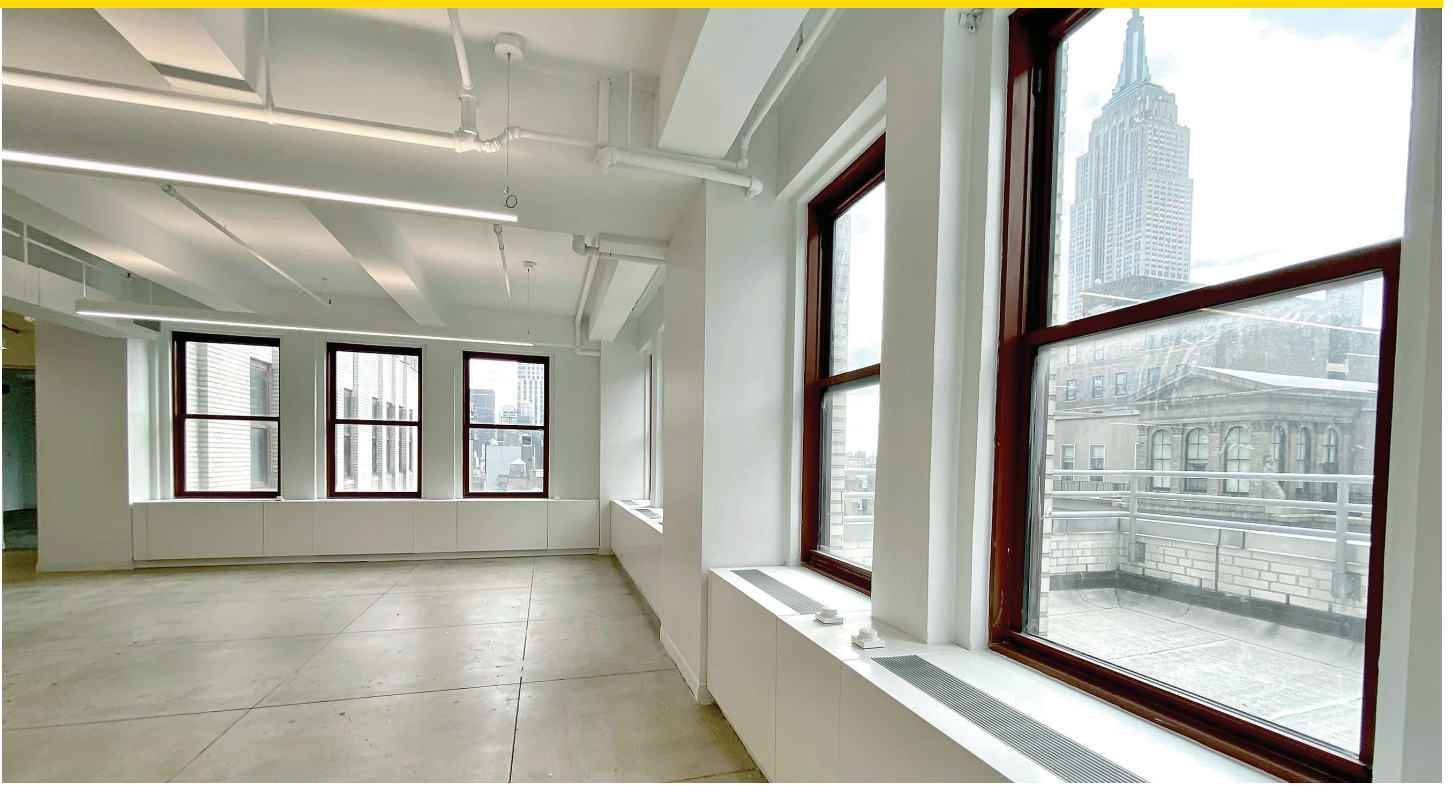

[Click here for virtual tour](#)



**SUBLEASE** 1400 Broadway, New York, NY 10018 | Penn Plaza/Garment Submarket



[Click here for virtual tour](#)



**SUBLEASE** 1400 Broadway, New York, NY 10018 | Penn Plaza/Garment Submarket



[Click here for virtual tour](#)



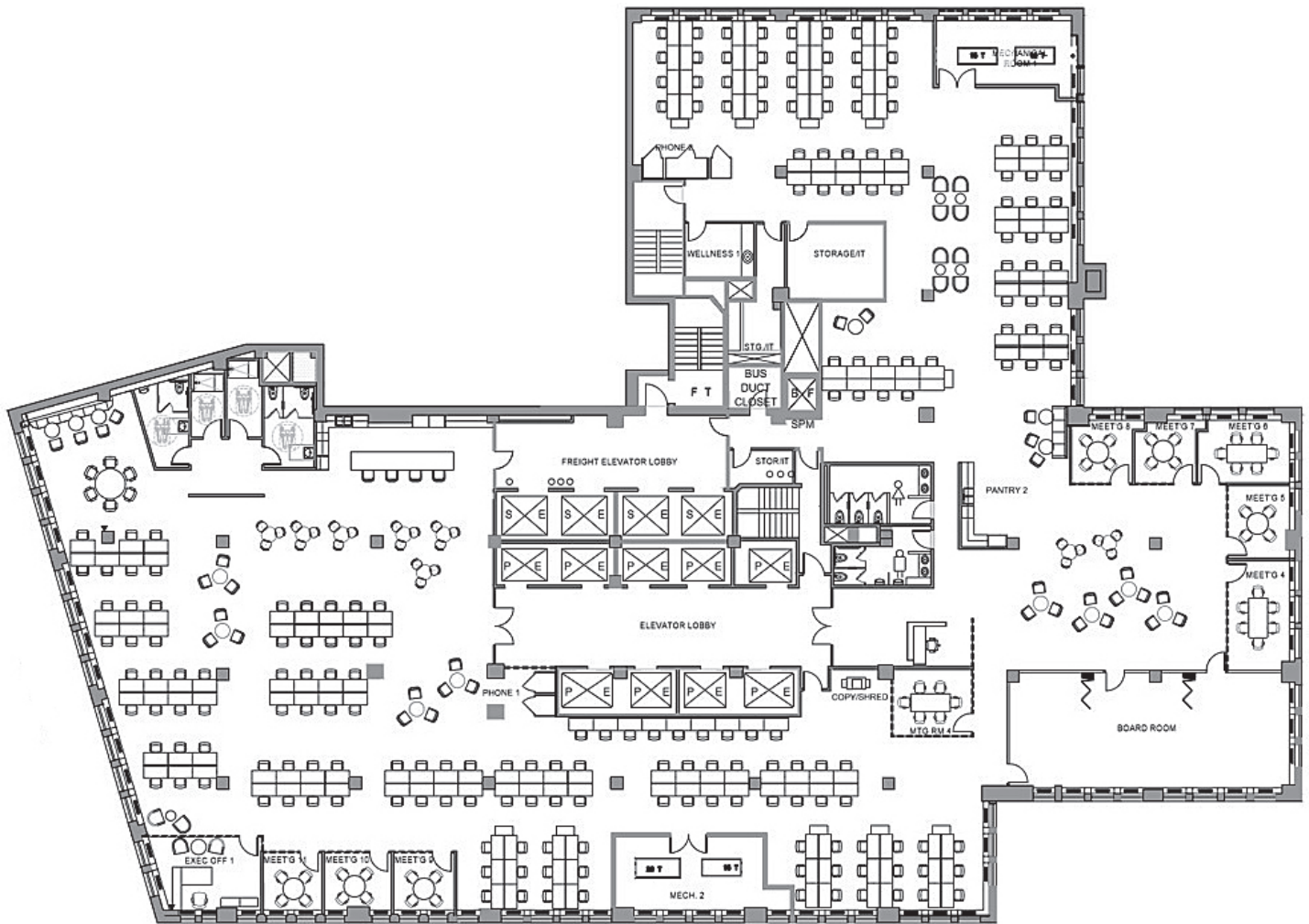

## Space Overview

**10** offices/meeting rooms

**1** large board room

**2** pantries

**2** private showers

open area for 190+