



400  
MADISON  
AVENUE







## Partial 3rd Floor 5,998 RSF

Possession: Immediate  
Term: 7/31/2023

- Plug and Play
- Steps from Grand Central Terminal access
- Building Tenant Lounge / Amenity Center

A “Plug & Play” partial 3rd Floor sublease at 5,998 RSF, employees can move right in and enjoy the Tenant Lounge and Amenity Center.

A quick walk to Grand Central Terminal, close to Times Square and the Garment District, surrounded by endless shopping and services, 400 Madison Avenue has highly desired building perks in a sought-after NYC neighborhood to work in.







EAST 47th STREET

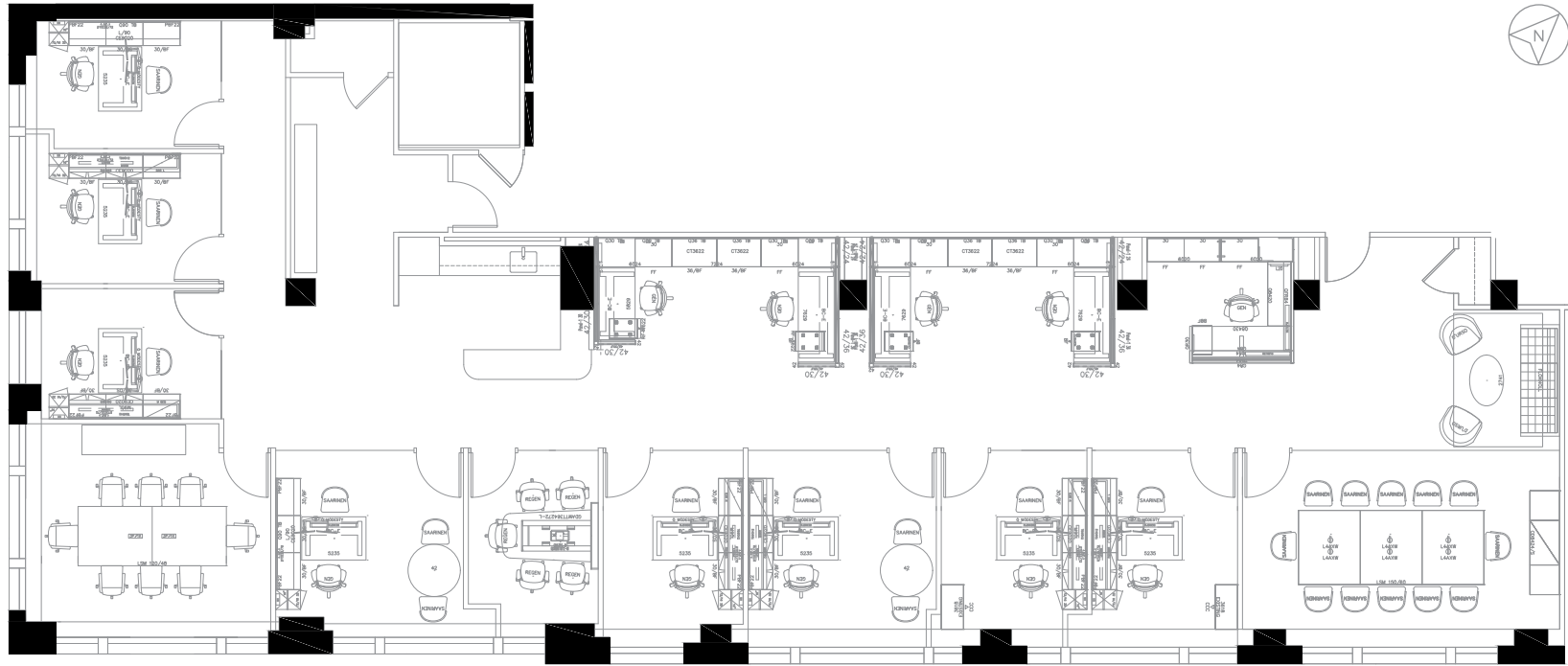

MADISON AVENUE

400  
MADISON  
AVENUE

