



2ND FLOOR



OFFICE SPACE FOR LEASE

Space:

Full 2nd Floor

Size:

6,750 sf

Below Market Rent:

Now \$32 psf

Building Notes:

24/7 access
Attended lobby
Intercom system
2 passenger elevators
Separate freight entrance / freight elevator

Space Notes:

Full floor
Direct elevator exposure
Oversized windows
Excellent natural light
High ceilings
Polished concrete floors
Large rooms throughout the floor
Private restrooms
Landlord would build-to-suit



*Attended lobby, intercom system
and 24/7 building access.*

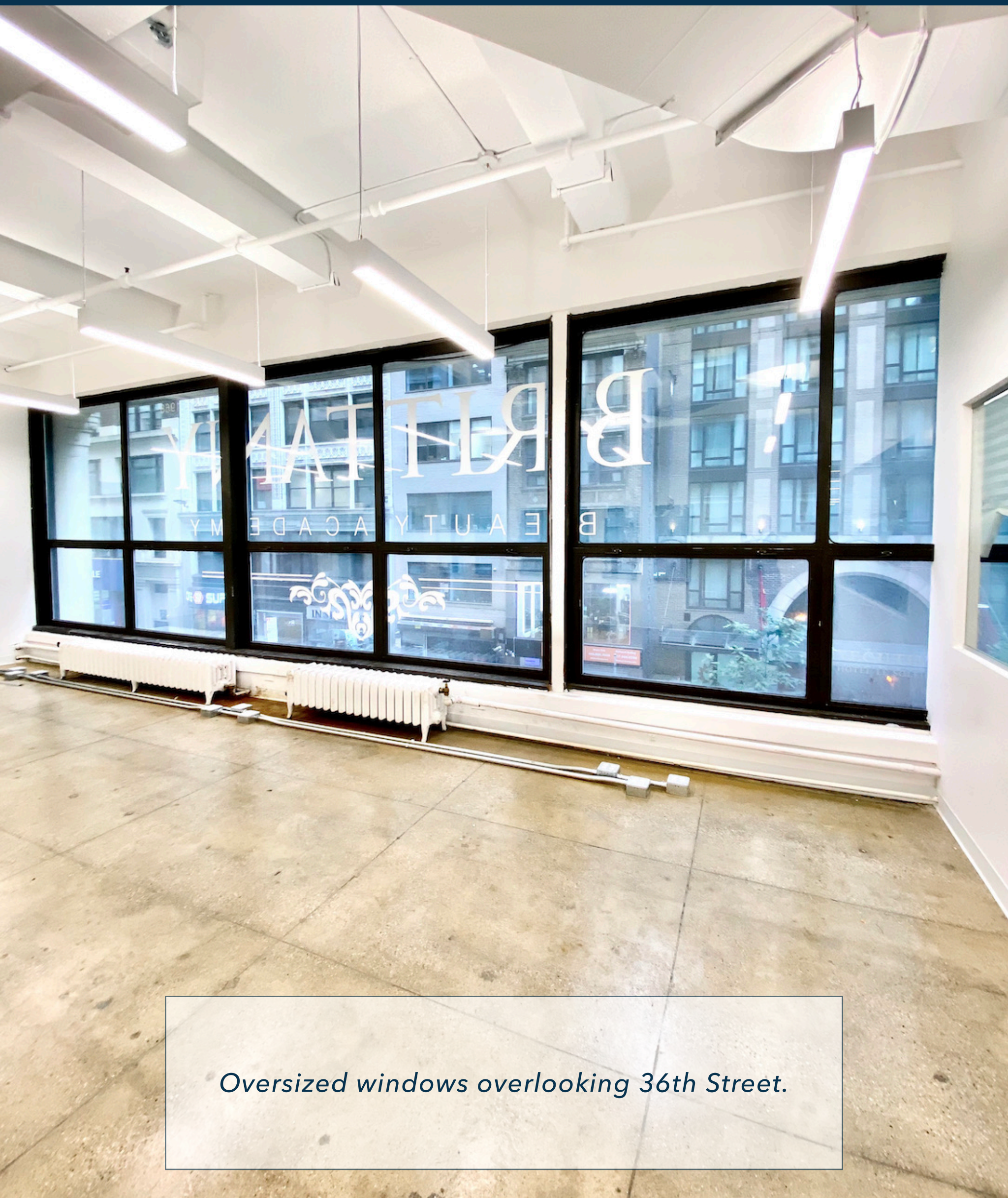

Oversized windows overlooking 36th Street.

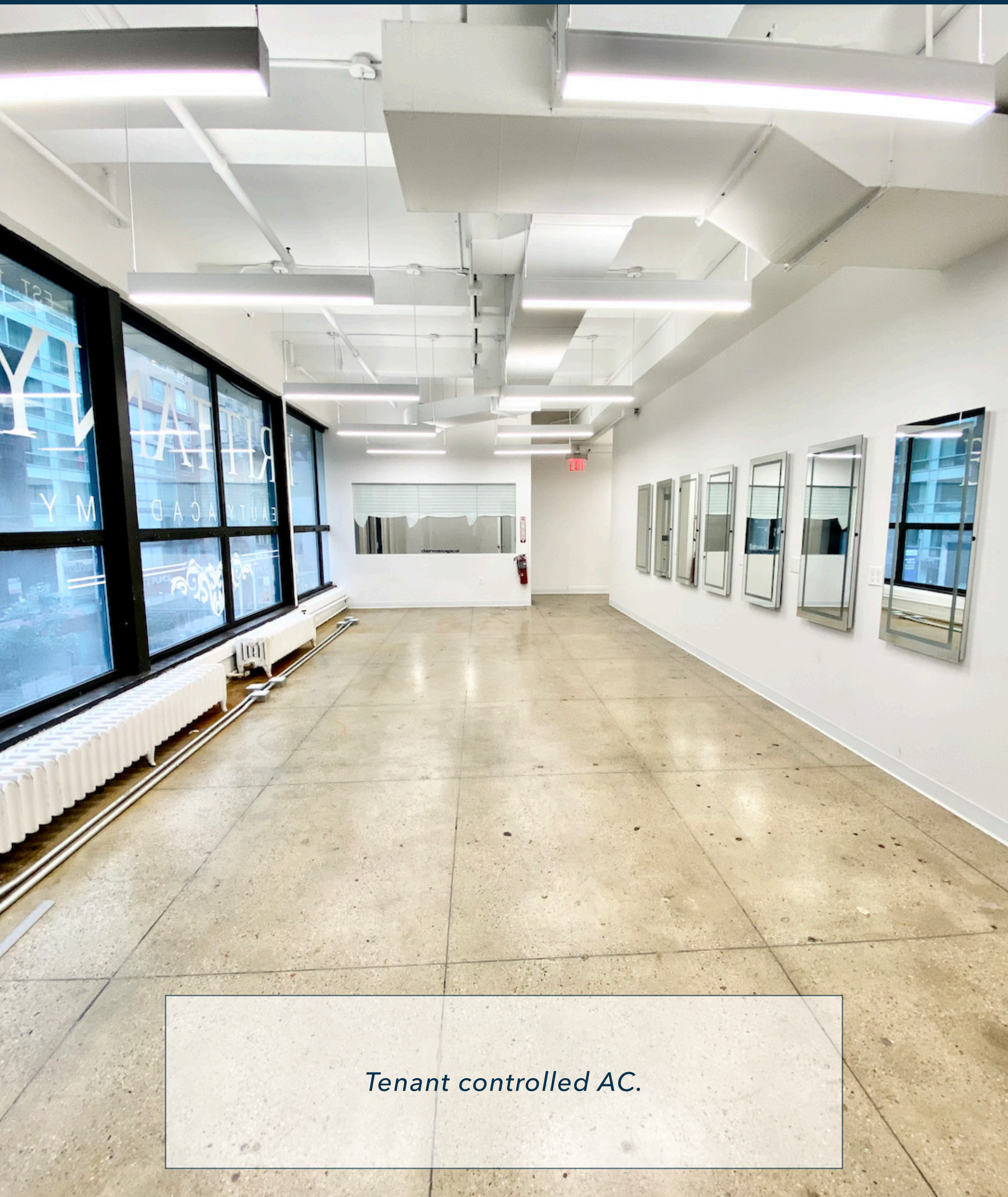

Tenant controlled AC.



High ceilings and polished concrete floors.



Multiple large rooms throughout the floor.



Private room with a private restroom.



Excellent natural light.



*Located on 36th Street
between 5th Avenue and 6th Avenue.*