

PENN1

Partial Twenty-First Floor for Sublease





Premises

7,115 SF

Term

August 2024

Possession

Immediate

Building Comments

- New building lobby and amenity center
- Exceptional building ownership and management
- Direct underground access to Penn Station, A/C/E and 1/2/3 subways

Space Comments

- Recently built and fully furnished
- Excellent views

7,115 SF

7,115 SF

34th Street

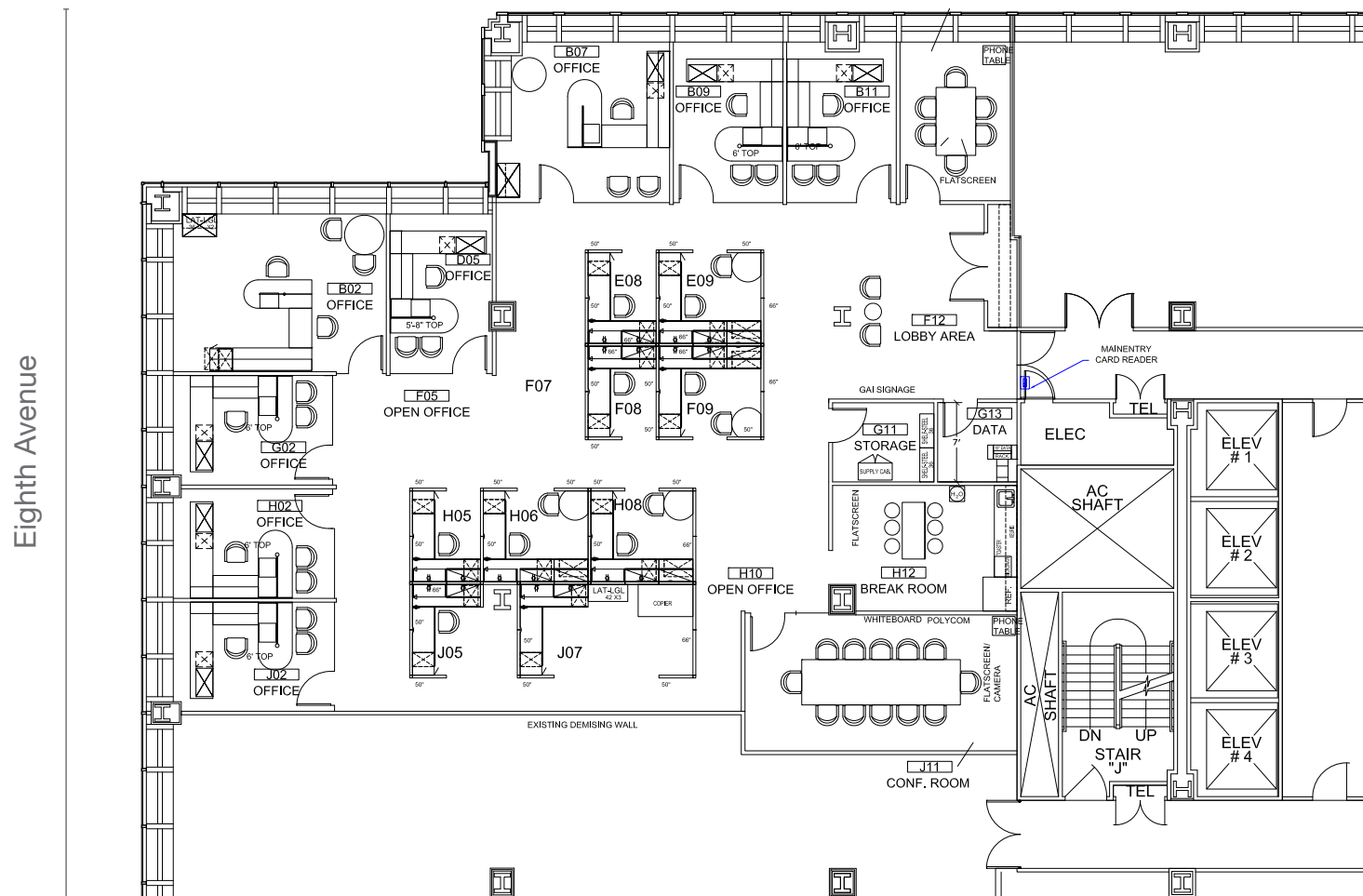

PENN¹

Partial Twenty-First Floor for Sublease

