



# For Sublease

## Move-in Condition

Premises: Partial 8th floor (Suite 810) : 8,137 RSF

Possession: Immediate

Term: Through May 30, 2027

Asking Rent: Upon Request

Electric: Submetered

Features:

## One Grand Central Place

(Between Park & Madison Avenue)

- Fully built & Furnished
- 15 offices, 11 workstations, 2 conference rooms
- Steps from Grand Central Terminal
- Credit SubLandlord

# One Grand Central Place

Partial Floor 8: 8,137 RSF

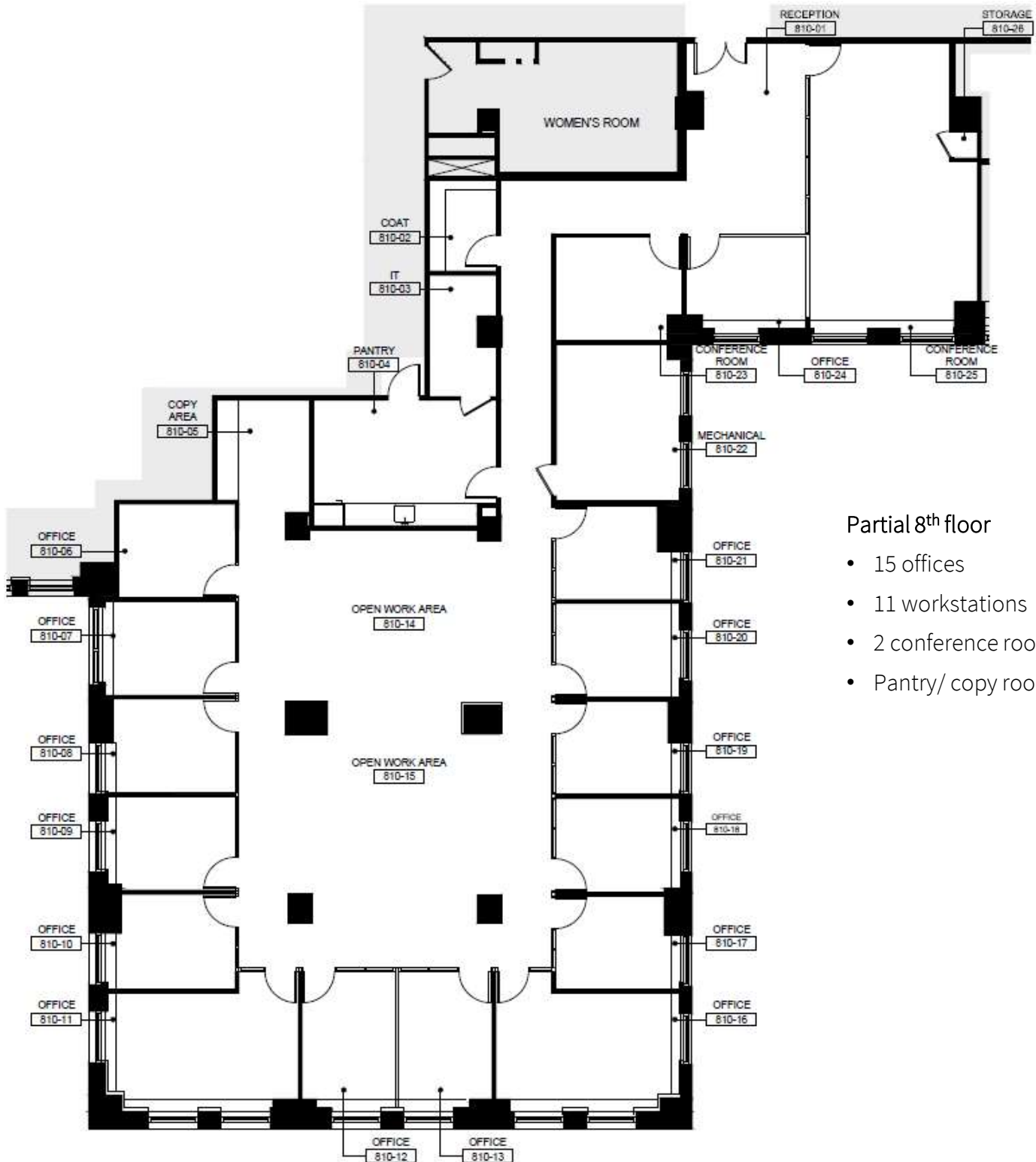

## Partial 8<sup>th</sup> floor

- 15 offices
- 11 workstations
- 2 conference rooms
- Pantry/ copy room



# One Grand Central Place – P. Floor

## 8

