

355 LEXINGTON AVENUE

NORTHEAST CORNER OF EAST 40TH STREET & LEXINGTON AVENUE



8,790 RSF

ENTIRE 18TH FLOOR

RENT
UPON REQUEST

POSSESSION
ARRANGED

SUBLEASE TERM
THRU 5/17/2024
WILL CONSIDER SHORTER TERM

ELECTRIC
\$3.00 PSF

HIGHLIGHTS

- EXCELLENT UNOBSTRUCTED SOUTHERN VIEWS
- WINDOWS ON FOUR SIDES
- THREE GLASS WALLED PERIMETER OFFICES
- TWO GLASS WALLED CONFERENCE ROOMS
- INT. BREAKOUT ROOM/WELLNESS ROOM/PANTRY
- LARGE OPEN AREA CAN BENCH UP TO 64 POSITIONS
- FURNITURE AVAILABLE
- CLEANING INCLUDED
- EXCELLENT BUILDING OWNERSHIP & TENANT ROSTER
- SPACE IS FULLY WIRED – READY TO MOVE IN



VIEW FROM THE 18TH FLOOR

355 LEXINGTON AVENUE

NORTHEAST CORNER OF EAST 40TH STREET & LEXINGTON AVENUE

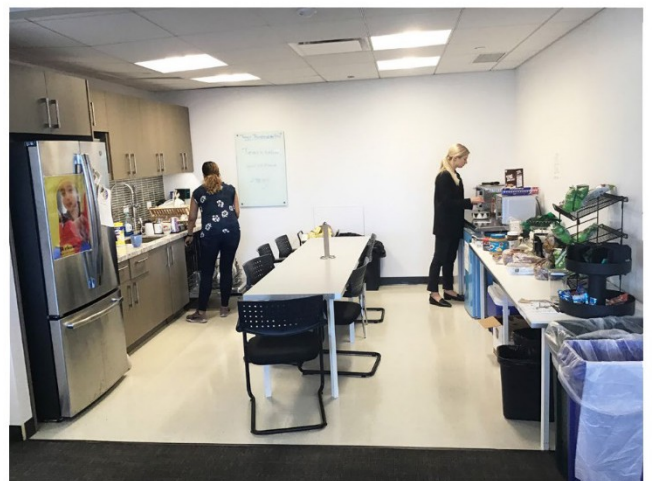
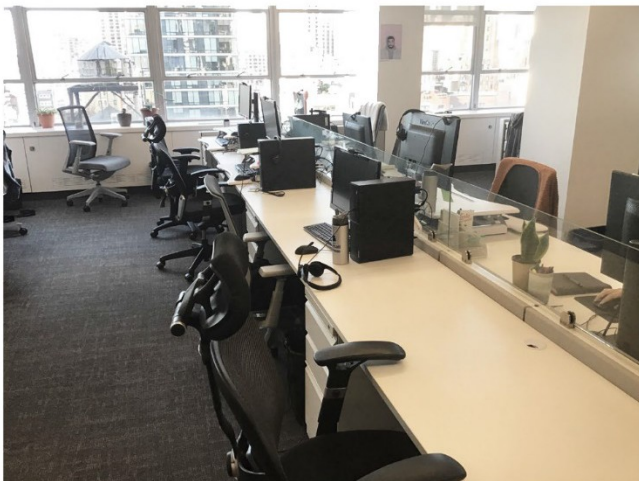

355 LEXINGTON AVENUE

NORTHEAST CORNER OF EAST 40TH STREET & LEXINGTON AVENUE

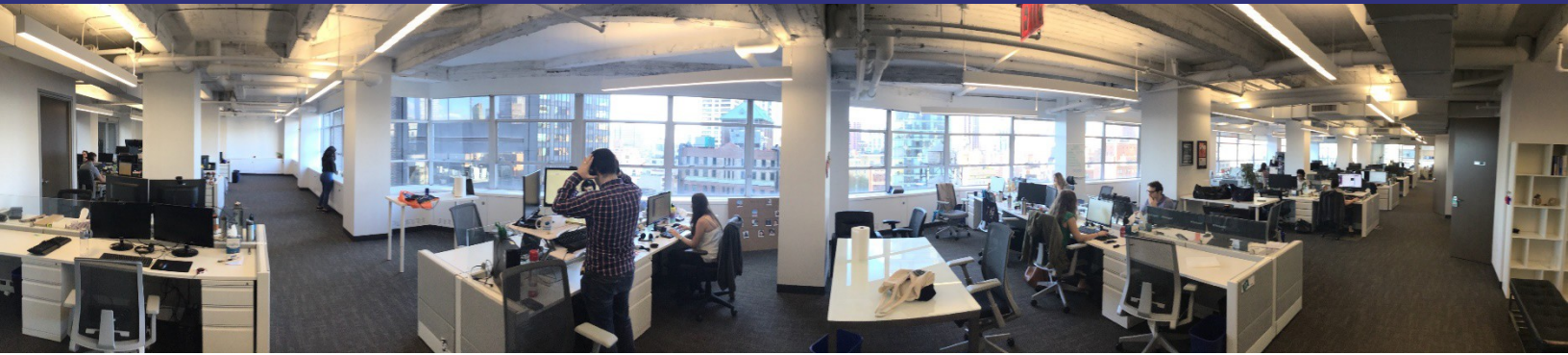

18TH FLOOR

8,790 RSF

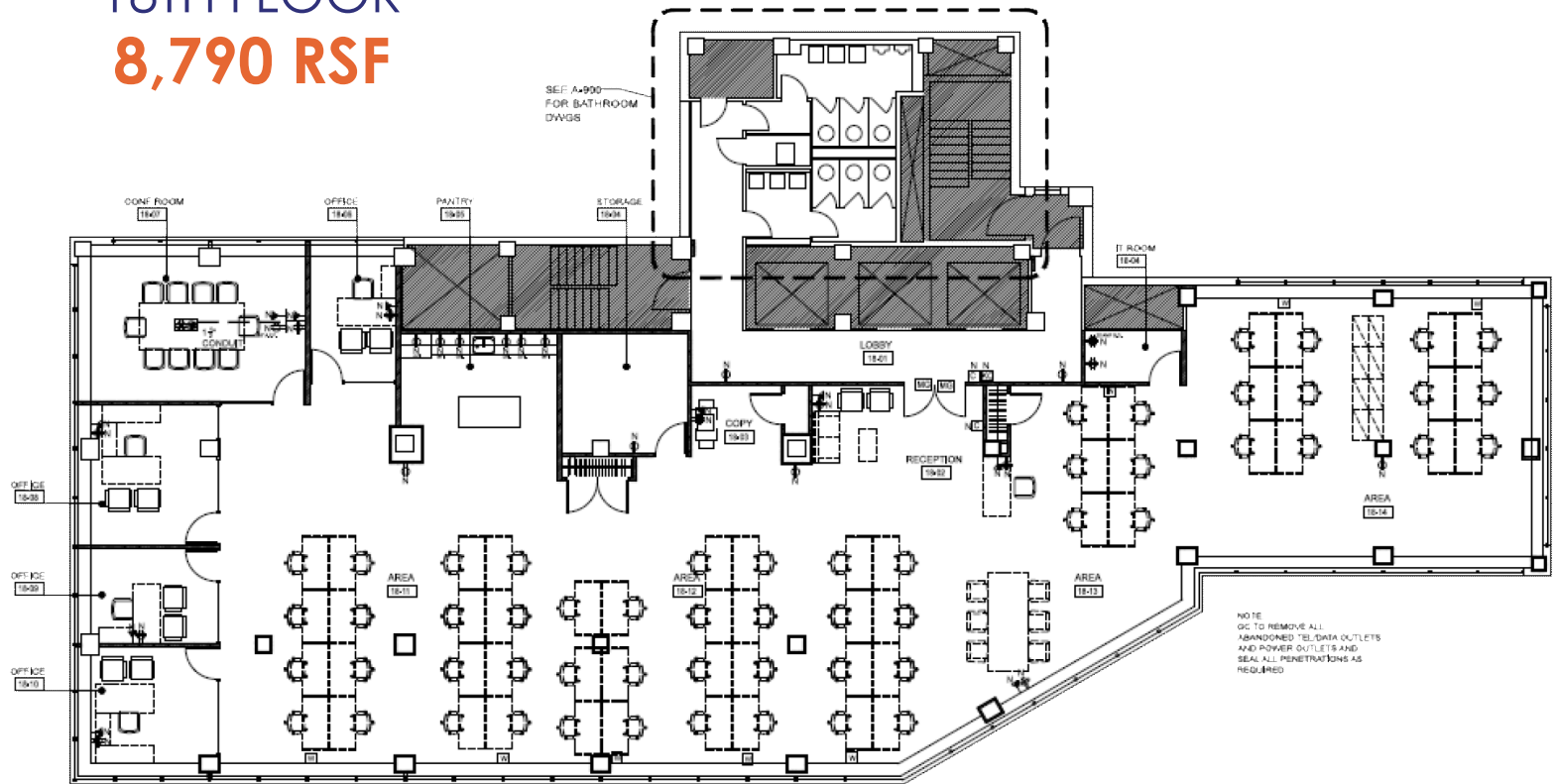

355 LEXINGTON AVENUE

NORTHEAST CORNER OF EAST 40TH STREET & LEXINGTON AVENUE

