

419

PARK AVENUE SOUTH

INDUSTRIAL CHIC

NEW SUBLEASE OPPORTUNITY

PLUG & PLAY



PROPERTY OVERVIEW

- Entire 16th Floor: 9,000 RSF
- Term through November 29, 2024
- Available Immediately
- Pricing Upon Request
- Built and fully furnished
- Located equidistant between Grand Central and Union Square
- Multinational institutional quality sublandlord

5 Conference Rooms



36 Workstations



4 Offices



Tenant Reception Area



Open Function Space



Floor Plan

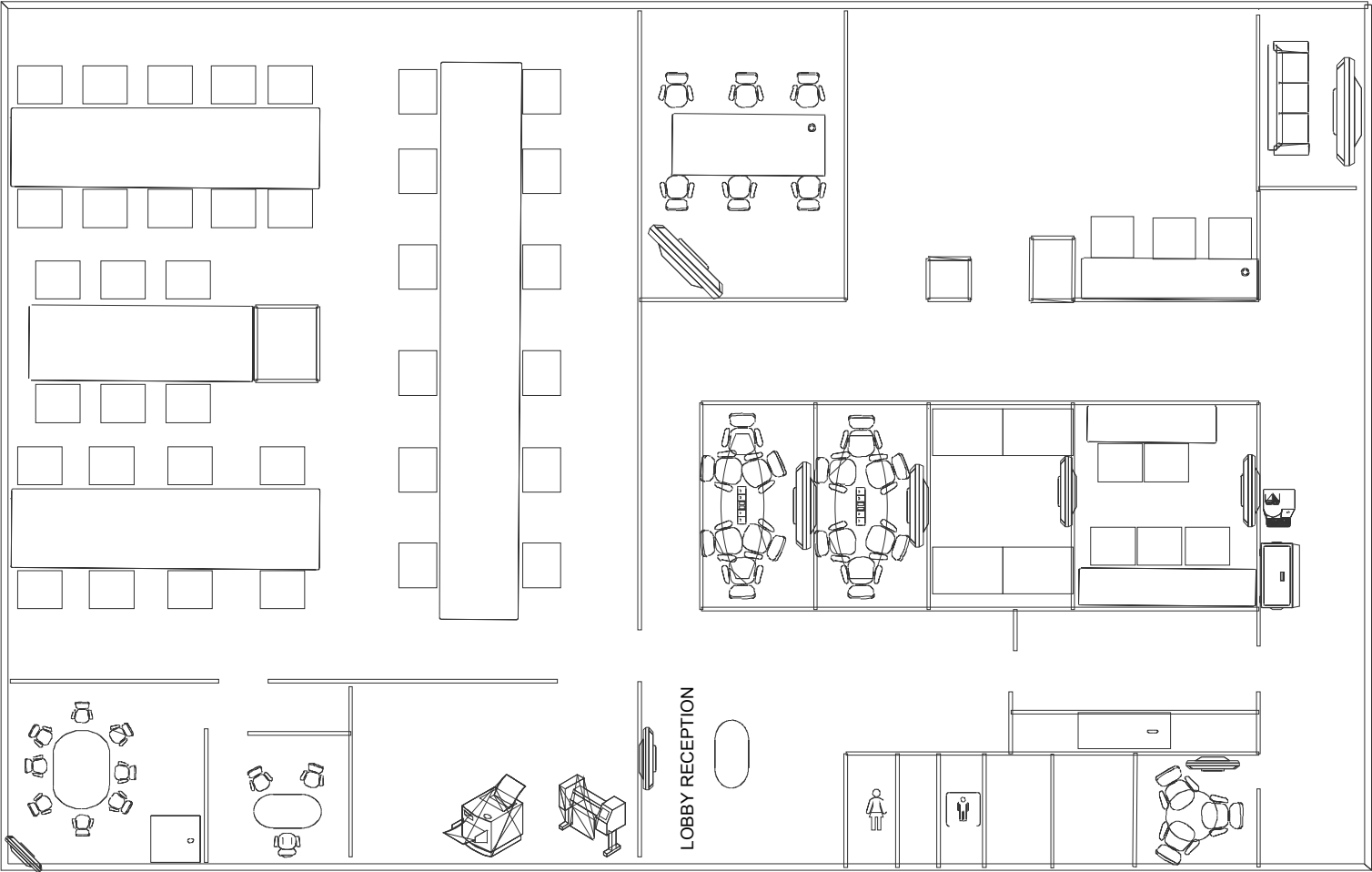

Views

